



INVICTA

www.invictawatch.com

INVICTA WATCH GROUP

INVICTA WATCH EUROPE	CORPORATE HEADQUARTERS
Veldweg 6G	1 Invicta Way (3069 Taft Street)
5321 JE Hedel	Hollywood, Florida 33021
the Netherlands	U.S.A.
Tel: +31(0)73-5995660	Tel: (800) 327-7682 (954) 921-2444
E-mail: wim@invictawatch.nl	Fax: (954) 921-4222 (954) 921-2508
Website: www.invictawatch.com	E-mail: sales@invictawatch.com

© Invicta Watch Group, Inc. 2011. All rights reserved.

INVICTA

SOME MYTHS ARE REAL. THE 2011 COLLECTION

INVICTA • 2011 COLLECTION



SOME MYTHS ARE REAL

ONCE UPON A TIME, A LITTLE COMPANY HAD THE AUDACITY TO DARE TO CONTEND WITH THE BIG GUYS. THE LITTLE COMPANY WENT OUT INTO THE GIANT WORLD OF WATCHES AND GATHERED ALL THE KNOWLEDGE AND EXPERTISE IT WOULD REQUIRE TO PRODUCE TIMEPIECES OF UNBEATABLE QUALITY YET MAKING THEM AFFORDABLE TO ALL. MAINTAINING ITS ORIGINAL MISSION, THIS COMPANY RALLIED FOR THE SMART BUYER AND HAS CONSISTENTLY BROUGHT CUSTOMERS AND COLLECTORS THE UTMOST VALUE FOR THEIR MONEY.

TIME HAS BEEN ON OUR SIDE, AND SINCE THOSE EARLY DAYS OUR LITTLE COMPANY HAS GROWN TOGETHER WITH OUR CUSTOMERS. IT HAS BEEN SHAPED BY THE VOICES OF OUR FANS IN MAKING THEIR WISHES COME TRUE. IT HAS BEEN LED BY INNOVATION AND NURTURED BY CONSISTENCY OF PRODUCT QUALITY AND BRAND PERSONALITY.

ONCE A MYTH, A MISSION, A DREAM OF TURNING THE BALANCE OF POWER IS TODAY A REALITY. WITH PRIDE FOR OUR ACHIEVEMENTS WE SALUTE OUR CUSTOMERS, OUR FANS, OUR ALLIES THAT HAVE PUSHED US, SUPPORTED US, INSPIRED US AND PROVED TO US THAT INDEED, SOME MYTHS ARE REAL.

ON THE COVER: SEA HUNTER CHRONO

INVICTA IS A REGISTERED TRADEMARK AND THE INTELLECTUAL PROPERTY OF INVICTA WATCH GROUP. TRADE MARKS, SERVICE MARKS, LOGOS, TRADE NAMES, DESIGNS, IMAGES AND COPYRIGHTS ARE RESERVED. NONE OF THE ABOVE MAY BE REPRODUCED WITHOUT AUTHORIZATION. INVICTA RESERVES THE RIGHT AT ALL TIMES TO MODIFY MODELS. DESCRIPTIONS, DESIGNS, AND PRICES WITHOUT ADVANCED NOTIFICATION.

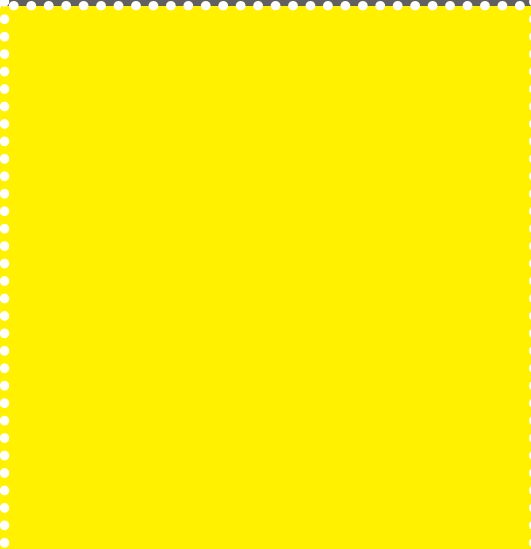
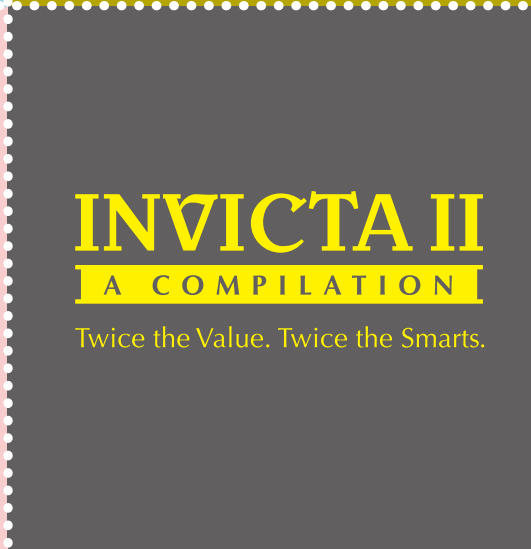
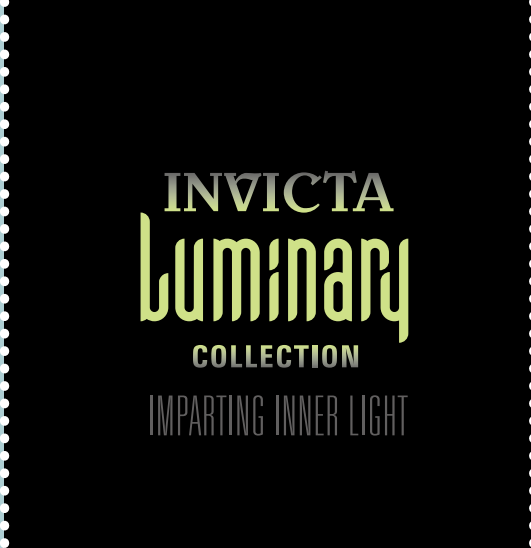

- SEA HUNTER
- RESERVE
- AKULA
- SUNAQUA
- LUMINARY
- SEA SPIDER
- RUSSIAN DIVER
- S1
- COALITION FORCE
- CORDUBA
- PRO DIVER
- SPEEDWAY
- FORCE
- VINTAGE
- LUPAH
- ANGEL
- II
- JEWELRY
- PACKAGING & DISPLAY

INVICTA

PRO DIVER



SEA HUNTER

MASTER OF THE OCEANS

A new masterpiece in timing has joined the ranks of the Pro Diver collection: the Invicta Sea Hunter. Prominently sized and ready to face depths up to 300 meters, the Invicta Sea Hunter arrives with a visionary purpose prepared to handle any level of intensity. Emboldened by Swiss-Made technical systems geared for the ultimate time mobility and function. Not for the faint of heart, the fierce volume and capability of the Sea Hunter pushes past barriers, delivering an unparalleled standard.



INVICTA

SEA HUNTER CHRONO

Movement: Professional Swiss made ETA A07.211 chronograph

Case and dial: ø 58 mm • Surgical grade solid stainless steel case • Unidirectional bezel with polyurethane ring on outer edge • Ionic gun metal plating . Ionic black plating

• Flame fusion crystal • Stainless steel screw down exhibition case back with colored crystal

• Stainless steel screw down crown and pushers • Double layer dial with colored luminous on the base

and cut through markers and numerals • Tritnite® luminous hands • Date display

Band: Black genuine leather strap with stainless steel buckle • Ionic gun metal plating

• Ionic black plating

Water resistant: 300 meters



Model 0602



Model 0603



Model 0604



Case Back



INVICTA
PRO DIVER
SEA HUNTER
MASTER OF THE OCEANS

INVICTA

SEA HUNTER CHRONO

Movement: Professional Swiss quartz chronograph movement with big date
Case and Dial: ø 58 mm • Surgical grade solid stainless steel case • Unidirectional bezel with polyurethane ring on outer edge • 18kt ionic gold plating • 18kt ionic rose gold plating • Flame fusion crystal • Stainless steel screw down exhibition case back with colored crystal
 • Stainless steel screw down crown and pushers • Carbon fiber dial with Tritnite® luminous indexes and hands • Day and big date display
Band: Black polyurethane strap with stainless steel buckle • 18kt ionic gold plating • 18kt ionic rose gold plating
Water Resistant: 300 meters



Model 0415



Model 0416



Case Back

INVICTA

SEA HUNTER CHRONO

Movement: Professional Swiss quartz chronograph movement with big date
Case and Dial: ø 58 mm • Surgical grade solid stainless steel case • Unidirectional bezel with polyurethane ring on outer edge • Ionic gun metal plating • Ionic black plating • Flame fusion crystal • Stainless steel screw down exhibition case back with colored crystal • Stainless steel screw down crown and pushers • Carbon fiber dial with Tritnite® luminous indexes and hands • Day and big date display
Band: Black polyurethane strap with stainless steel buckle • Ionic gun metal plating • Ionic black plating
Water Resistant: 300 meters



Model 0414



Model 0413



Model 0412



Case Back

INVICTA

SEA HUNTER CHRONO

Movement: Professional Swiss quartz chronograph movement with big date
Case and Dial: ø 58mm • Surgical grade solid stainless steel case • Unidirectional bezel with polyurethane ring on outer edge • Flame fusion crystal • Stainless steel screw down exhibition case back with colored crystal • Stainless steel screw down crown and pushers • Genuine mother of pearl dial with Tritnite® luminous indexes and hands • Day and big date display
Band: Polyurethane strap with stainless steel buckle
Water Resistant: 300 meters



Model 0859



Model 0860



Model 0861



Case Back



INVICTA
 PRO DIVER

 SEA HUNTER
 MASTER OF THE OCEANS



INVICTA RESERVE

FOR THE FEW WHO KNOW BEST

The exceptional taste and distinguished palate of the connoisseur will discover timeless pleasure within the Invicta Reserve Collection. Specially developed for those in the know, The Reserve Collection is a reinvention of the superb to create the ultimate in horological finery. These limited quantity; exclusively hand-made timepieces represent a pinnacle in superiority for the discerning aficionado.



INVICTA

RESERVE EXTREME MOON PHASE

Movement: Swiss made automatic chronograph ETA7751

- Specially designed rotor plate with Reserve logo

Case and dial: ø 47 mm • Surgical grade solid stainless steel in combination brush and shiny finish

- 18kt gold plating • Ionic black plating • Unidirectional turning bezel • Flame fusion crystal
- Stainless steel skeleton exhibition case back fitted with 8 screws • Stainless steel screw down crown and pushers with Reserve logo etched on the crown • Genuine meteorite dial obtained from Gibeon Meteorite
- Tritnite® luminous indexes and hands • Mother, Day, Date and moon phase display

Band: Surgical grade solid stainless steel with dual push button deployment buckle

- Solid plate with Invicta Reserve logo etched on it • 18kt gold plating • Ionic black plating

Water resistant: 200 meters



Model 0210



Model 0211



Case Back

INVICTA

RESERVE EXTREME

Movement: Professional Swiss automatic chronograph

Case and dial: ø 47 mm • Surgical grade solid stainless steel case with unidirectional bezel

- Flame fusion crystal • Invicta etched on the case side • Stainless steel screw down exhibition case back
- Stainless steel screw down crown and pushers with Reserve logo etched on the crown
- Texture dials with Tritnite® luminous indexes and hands • Date display

Band: Surgical grade solid stainless steel band with solid divers buckle and safety clasp

Water resistant: 300 meters



Model 0605



Model 0607



Model 0606



Case Back

INVICTA
AUTO RESERVE CADET

Movement: Professional Swiss automatic chronograph

- Case and dial: ø 48 mm • Surgical grade solid stainless steel case with fixed top ring
- 18kt gold plating • 18kt rose gold plating • Ionic black plating • Flame fusion crystal • Invicta etched on the case side • Stainless steel screw down exhibition case back • Stainless steel crown and pushers with Reserve logo etched on the crown • Textured dials with Tritnite® luminous indexes and hands • Date display
- Band: Surgical grade stainless steel band in combination brushed and shiny finish with push button deployment buckle with machine cut texture on it • 18kt gold plating • 18kt rose gold plating
- Ionic black plating
- Water resistant: 100 meters



Model 0592

Model 0593

INVICTA
AUTO RESERVE CADET

Movement: Professional Swiss automatic chronograph

- Case and dial: ø 48 mm • Surgical grade solid stainless steel case with fixed top ring
- Ionic black plating • Flame fusion crystal • Invicta etched on the case side • Stainless steel screw down exhibition case back • Stainless steel crown and pushers with Reserve logo etched on the crown • Textured dials with Tritnite® luminous indexes and hands • Date display
- Band: Surgical grade stainless steel band in combination brushed and shiny finish with push button deployment buckle with machine cut texture on it • Ionic black plating
- Water resistant: 100 meters



Model 0591

Model 0594



Case Back



Case Back

INVICTA

RESERVE ELEGANT EXTREME

Movement: Professional automatic chronograph • Specially designed Invicta rotor plate

Case and dial: ø 47 mm • Surgical grade solid stainless steel with unidirectional bezel

• 18kt gold plating • Flame fusion crystal • Invicta etched on the case side

• Stainless steel screw down exhibition case back • Stainless steel crown and pushers with Reserve logo on crown • Carbon fiber dials • Tritnite® luminous indexes and hands • Date display

Band: Surgical grade stainless steel band in combination brushed and shiny finish with push button deployment buckle with machine cut texture on it • 18kt gold plating

Water resistant: 100 meters



Model 0742



Model 0741



Case Back



INVICTA
RESERVE

FOR THE FEW WHO KNOW BEST

INVICTA
ARSENAL II CHRONO

Movement: Professional Swiss quartz chronograph with big date
Case and dial: ø 56 mm • Surgical grade solid stainless steel with unidirectional bezel • 18kt gold plating
• Ionic black plating • Flame fusion crystal • Solid stainless steel screw down case back
• Stainless steel screw down crown • Tritnite® luminous indexes and hands • Day and big date display
Band: Surgical grade stainless steel band with solid diver buckle and safety clasp • 18kt gold plating
• Ionic black plating
Water resistant: 300 meters



Model 0340
MOP

Model 0341
MOP

INVICTA
ARSENAL II CHRONO

Movement: Professional Swiss quartz chronograph with big date
Case and dial: ø 56 mm • Surgical grade solid stainless steel with unidirectional bezel
• Ionic gun metal plating • Ionic black plating • Flame fusion crystal
• Solid stainless steel screw down case back • Stainless steel screw down crown
• Tritnite® luminous indexes and hands • Day and big date display
Band: Surgical grade stainless steel with diver buckle and safety clasp • Ionic gun metal plating
Water resistant: 300 meters



Model 0335

Model 0336

INVICTA
ARSENAL II CHRONO

- Movement:** Professional Swiss quartz chronograph with big date
- Case and dial:** ø 56 mm • Surgical grade solid stainless steel with unidirectional bezel
- 18kt ionic gold plating • Ionic black plating • Flame fusion crystal
- Solid stainless steel screw down case back • Stainless steel screw down crown with Reserve logo on it
- Tritnite® luminous indexes and hands • Day and big date display
- Band:** Surgical grade stainless steel band with diver buckle and safety clasp • 18kt gold plating
- Ionic black plating
- Water resistant:** 300 meters



Model 0337
MOP

INVICTA
ARSENAL II CHRONO

- Movement:** Professional Swiss quartz chronograph with big date
- Case and dial:** ø 56 mm • Surgical grade solid stainless steel with unidirectional bezel
- Ionic gun metal plating • Ionic black plating • Flame fusion crystal
- Solid stainless steel screw down case back • Stainless steel screw down crown with Reserve logo on it
- Tritnite® luminous indexes and hands • Day and big date display
- Band:** Surgical grade stainless steel band with solid diver buckle and safety clasp • Ionic gun metal plating
- Ionic black plating
- Water resistant:** 300 meters



Model 0339



Model 0338

INVICTA

LADY OCEAN REEF DIAMOND PAVE

Movement: Professional Swiss quartz chronograph

Case and dial: ø 40 mm • Surgical grade solid stainless steel with unidirectional bezel • 18kt gold plating • 18kt rose gold plating • Flame fusion crystal • 156 genuine white diamonds hand set on the bezel in a 4 prong jeweler's setting • 48 genuine white diamonds hand set on the case lugs in a 4 prong jeweler's setting • Reserve logo etched on the case side • Stainless steel screw down case back • Stainless steel screw down crown and pushers with Reserve logo etched on the crown • Pave dial with total 257 white diamonds hand set on it • Genuine mother of pearl sub dials • Tritnite® luminous hands

Band: Surgical grade stainless steel with center link in white textured polyurethane • Push button deployment buckle with machine cut texture on it • 18kt gold plating • 18kt rose gold plating

Water resistant: 200 meters



Model 0188



Model 0189



Model 0187

INVICTA

LADY OCEAN REEF DIAMOND

Movement: Professional Swiss quartz chronograph

Case and dial: ø 40 mm • Surgical grade solid stainless steel with unidirectional bezel • 18kt gold plating • 18kt rose gold plating • Flame fusion crystal • 156 genuine white diamonds hand set on the bezel in a 4 prong jeweler's setting • 48 genuine white diamonds hand set on the case lugs in a 4 prong jeweler's setting • Reserve logo etched on the case side • Stainless steel screw down case back • Stainless steel screw down crown and pushers with Reserve logo etched on the crown • Genuine mother of pearl dial with total 24 white diamonds hand set on index positions • Tritnite® luminous hands

Band: Surgical grade stainless steel with center link in coloured textured polyurethane • Push button deployment buckle with machine cut texture on it • 18kt gold plating • 18kt rose gold plating

Water resistant: 200 meters



Model 0183
MOP



Model 0184
MOP



Model 0185
MOP



Model 0186
MOP

INVICTA

LADY OCEAN REEF DIAMOND

Movement: Professional Swiss quartz chronograph

Case and dial: ø 40 mm • Surgical grade solid stainless steel with unidirectional bezel

- Flame fusion crystal • 156 genuine white diamonds hand set on the bezel in a 4 prong jeweler's setting
- 48 genuine white diamonds hand set on the case lugs in a 4 prong jeweler's setting

- Reserve logo etched on the case side • Stainless steel screw down case back • Stainless steel screw down crown and pushers with Reserve logo etched on the crown • Genuine mother of pearl dial with total 24 white diamonds hand set on index positions • Tritnite® luminous hands

Band: Surgical grade stainless steel with center link in coloured textured polyurethane

- Push button deployment buckle with machine cut texture on it

Water resistant: 200 meters



Model 0177
MOP



Model 0178
MOP



Model 0179
MOP



Model 0180
MOP



Model 0181
MOP



Model 0182
MOP

INVICTA

LADY OCEAN REEF DIAMOND

Movement: Professional Swiss quartz chronograph

Case and dial: ø 40 mm • Surgical grade solid stainless steel with unidirectional bezel

- Flame fusion crystal • 156 genuine white diamonds hand set on the bezel in a 4 prong jeweler's setting
- 48 genuine white diamonds hand set on the case lugs in a 4 prong jeweler's setting

- Reserve logo etched on the case side • Stainless steel screw down case back • Stainless steel screw down crown and pushers with Reserve logo etched on the crown • Genuine mother of pearl dial with total 24 white diamonds hand set on index positions • Tritnite® luminous hands

Band: Surgical grade stainless steel with center link in coloured textured polyurethane

- Push button deployment buckle with machine cut texture on it

Water resistant: 200 meters

INVICTA

LADY OCEAN REEF DIAMOND

Movement: Professional Swiss quartz chronograph

Case and dial: ø 40 mm • Surgical grade solid stainless steel with unidirectional rotating bezel with coloured numerical polyurethane ring • 18kt gold plating • 18kt rose gold plating

- Flame fusion crystal • Reserve logo etched on the case side • Stainless steel screw down case back
- Stainless steel screw down crown and pushers with Reserve logo etched on the crown • Genuine mother of pearl dial with 24 white diamonds hand set on index positions • Tritnite® luminous hands

Band: Surgical grade stainless steel with center link in coloured textured polyurethane • Push button deployment buckle with machine cut texture on it • 18kt gold plating • 18kt rose gold plating

Water resistant: 200 meters



Model 0170
MOP



Model 0174
MOP

INVICTA

LADY OCEAN REEF DIAMOND

Movement: Professional Swiss quartz chronograph

Case and dial: ø 40 mm • Surgical grade solid stainless steel with unidirectional rotating bezel with coloured numerical polyurethane ring • Flame fusion crystal • Reserve logo etched on the case side

- Stainless steel screw down case back • Stainless steel screw down crown and pushers with Reserve logo etched on the crown • Genuine mother of pearl dial with 24 white diamonds hand set on index positions • Tritnite® luminous hands

Band: Surgical grade stainless steel with center link in coloured textured polyurethane • Push button deployment buckle with machine cut texture on it

Water resistant: 200 meters



Model 0166
MOP



Model 0167
MOP



Model 0168
MOP



Model 0169
MOP

INVICTA

RESERVE BOLT CHRONOGRAPH

Movement: Professional Swiss chronograph • 22 jewels

Case and dial: ø 50 mm • Solid stainless steel case • Solid stainless steel bezel with stainless steel jewelry rope design • Screw down solid stainless steel case back • Stainless steel screw down crown

• Flame fusion crystal • Double layered dial with inner ring • Date display

• Tritnite® luminous indexes and hands • 18kt gold plating • 18kt rose gold plating • Black ionic plating

Band: Solid stainless steel band with stainless steel butterfly buckle • 18kt gold plating

• 18kt rose gold plating • Black ionic plating

Water resistant: 200 meters



Model 5630



Model 5628



Model 5629



Model 5627

INVICTA

RESERVE BOLT CHRONOGRAPH

Movement: Professional Swiss chronograph • 22 jewels

Case and dial: ø 50 mm • Solid stainless steel case • Solid stainless steel bezel with stainless steel jewelry rope design • Screw down solid stainless steel case back • Stainless steel screw down crown

• Flame fusion crystal • Double layered dial with inner ring • Date display

• Tritnite® luminous indexes and hands • Black ionic plating • Gun ionic plating

Band: Solid stainless steel band with stainless steel butterfly buckle • Black ionic plating

• Gun ionic plating

Water resistant: 200 meters

INVICTA

RESERVE BOLT CHRONOGRAPH FLEX

Movement: Professional Swiss chronograph quartz with big date

Case and dial: ø 50 mm • Solid stainless steel case • Solid stainless steel bezel with stainless jewelry rope design • Stainless steel screw down case back • Flame fusion crystal • Stainless steel screw crown with etched reserve logo • Shiny dial in black color • Date display • Tritnite® luminous hands • Black ionic plating

Band: High grade polyurethane strap in black color with stainless steel metal inserts

• Stainless steel buckles with logo • Black ionic plating

Water resistant: 200 meters



Model 6940

INVICTA

RESERVE BOLT CHRONOGRAPH FLEX

Movement: Professional Swiss chronograph quartz with big date

Case and dial: ø 50 mm • Solid stainless steel • Solid stainless steel bezel with stainless steel jewelry rope design • Stainless steel screw down case back • Flame fusion crystal • Stainless steel screw crown with etched reserve logo • Genuine mother of pearl dial • Date display • Tritnite® luminous hands

Band: High grade polyurethane strap in yellow and red colors with stainless steel metal inserts

• Stainless steel buckles with logo

Water resistant: 200 meters



Model 6938
MOP



Model 6939
MOP

INVICTA

RESERVE BOLT CHRONOGRAPH FLEX

Movement: Professional Swiss quartz chronograph • 6 jewels

Case and dial: ø 50 mm • Solid stainless steel case • Stainless steel screw down case back

- Solid stainless steel bezel with stainless steel wire • Flame fusion crystal • Sunray dial in assorted colors
 - Stainless steel screw crown • Stainless steel pushers • Date display
 - Tritnite® luminous hands and indexes • Black ionic plating

Band: High grade polyurethane band with stainless steel metal inserts • Stainless steel buckle with logo

Water resistant: 200 meters



Model 6432



Model 6433



Model 6434

INVICTA

RESERVE BOLT GMT

Movement: Professional Swiss GMT quartz with date • 3 jewels

Case and dial: ø 50 mm • Solid stainless steel case • Stainless steel screw down case back

- Solid stainless steel bezel with stainless steel wire • Flame fusion crystal • Sunray dial in assorted colors with applied ring • Stainless steel screw crown • Stainless steel pushers • Date display
 - Tritnite® luminous hands and indexes • Black ionic plating

Band: High grade polyurethane band with stainless steel metal inserts • Stainless steel buckle with logo

Water resistant: 200 meters



Model 6435



Model 6436

INVICTA

RESERVE BOLT LADY

Movement: Professional Swiss chronograph quartz with big date • 3 jewels
Case and dial: ø 40 mm • Solid stainless steel case • Solid stainless steel bezel with stainless steel wire
 • Screw down stainless steel case back • Stainless steel screw crown with etched reserve logo
 and screw pushers • Flame fusion crystal • Genuine mother of pearl dial in assorted colors • Date display
 • Tritnite® luminous hands and indexes • 18kt rose gold plating • 18kt gold plating
Band: High grade polyurethane strap with stainless steel metal inserts • Stainless steel buckle with logo
 • 18kt rose gold plating • 18kt gold plating
Water resistant: 200 meters



Model 6950
MOP



Model 6947
MOP



Model 6944
MOP



Model 6951
MOP



Model 6948
MOP



Model 6945
MOP



INVICTA

RESERVE

FOR THE FEW WHO KNOW BEST

INVICTA
SPECIALTY RESERVE DIVER

Movement: Professional Swiss quartz chronograph • 13 jewels

- Case and dial: ø 52 mm • Solid stainless steel case with skeleton lugs with etched logo on case side
- Unidirectional bezel • Stainless steel case back with screws • Flame fusion crystal • Textured or sunray dial in assorted colors with applied rings • Stainless steel crown with etched Reserve logo
 - Date and day display • Tritnite® luminous hands and indexes • 18kt gold plating
- Band: Solid stainless steel band with stainless steel diver buckle with safety lock • 18kt gold plating

Water resistant: 500 meters



Model 6900

Model 6901



Model 6902

INVICTA
SPECIALTY RESERVE DIVER

Movement: Professional Swiss quartz chronograph • 13 jewels

- Case and dial: ø 52 mm • Solid stainless steel case with skeleton lugs with etched logo on case side
- Unidirectional bezel • Stainless steel case back with screws • Flame fusion crystal • Textured or sunray dial in assorted colors with applied rings • Stainless steel crown with etched Reserve logo
 - Date and day display • Tritnite® luminous hands and indexes • 18kt gold plating
- Band: Solid stainless steel band with stainless steel diver buckle with safety lock • 18kt gold plating

Water resistant: 500 meters



Model 6898

Model 6899



Model 6896



Model 6897

INVICTA

SPECIALTY SUBAQUA CHRONO

Movement: Professional Swiss quartz chronograph • 13 jewels

Case and dial: ø 52 mm • Solid stainless steel case with skeleton lugs • Unidirectional bezel

• Stainless steel case back with screws • Flame fusion crystal • Textured or sunray dial in assorted colors with applied rings • Stainless steel crown with etched Reserve logo

• Date and day display • Tritnite® luminous hands and indexes • 18kt gold plating

Band: High grade polyurethane strap with stainless steel metal inserts • Stainless steel buckle with logo • 18kt gold plating

Water resistant: 500 meters



Model 6905



Model 6906

INVICTA

SPECIALTY SUBAQUA CHRONO

Movement: Professional Swiss chronograph

Case and dial: ø 52 mm • Solid stainless steel case with skeleton lugs

• Reserve logo engraved on case side • Unidirectional bezel • Stainless steel case back fixed with 6 screws

• Flame fusion crystal • Stainless steel screw crown and pushers • Genuine mother of pearl dial with applied rings • Date display • Tritnite® luminous hands • Black ionic plating

Band: High grade polyurethane strap with stainless steel metal inserts

• Stainless steel buckle with logo • Black ionic plating

Water resistant: 500 meters



Model 0507
MOP



Model 0508
MOP



Model 0506
MOP

INVICTA

SPECIALTY SUBAQUA CHRONOGRAPH

Movement: Professional Swiss chronograph

Case and dial: ø 52 mm • Solid stainless steel case with skeleton lugs • Reserve logo engraved on case side
• Unidirectional bezel in titanium color • Stainless steel case back fixed with 6 screws

• Flame fusion crystal • Stainless steel screw crown and pushers • Genuine mother of pearl dial in light blue colors with applied rings • Date display • Tritnite® luminous hands

Band: High grade polyurethane strap with stainless steel metal inserts • Stainless steel buckle with logo

Water resistant: 500 meters



Model 0509

INVICTA

SPECIALTY SUBAQUA CHRONOGRAPH

Movement: Professional Swiss quartz chronograph • 13 jewels

Case and dial: ø 52 mm • Solid stainless steel case with skeleton lugs with etched logo on case side
• Unidirectional turning bezel • Stainless steel case back with screws • Flame fusion crystal

• Sunray dial with applied rings • Stainless steel crown with etched Reserve logo

• Date and day display • Tritnite® luminous hands and indexes

Band: High grade polyurethane strap with stainless steel metal inserts • Stainless steel buckle with logo

Water resistant: 500 meters



Model 6903



Model 6904

INVICTA

SPECIALTY SUBAQUA CHRONO MIDSIZE

Movement: Professional Swiss quartz chronograph

Case and dial: ø 44 mm • Solid stainless steel case with skeleton lugs • Reserve logo engraved on case side

- Stainless steel case back with fixed 6 screws • Flame fusion crystal • Stainless steel screw crown with etched Reserve logo • Genuine mother of pearl dial with applied ring • Date display
- Tritnite® luminous hands • 18kt gold plating

Band: High grade polyurethane strap in assorted colors with stainless steel metal inserts

- Stainless steel buckle with logo • 18kt gold plating

Water resistant: 500 meters



Model 0525
MOP



Model 0526
MOP



Model 0527
MOP



Model 0528
MOP

INVICTA

SPECIALTY SUBAQUA CHRONO MIDSIZE

Movement: Professional Swiss quartz chronograph

Case and dial: ø 44 mm • Solid stainless steel case with skeleton lugs • Reserve logo engraved on case side

- Stainless steel case back with fixed 6 screws • Flame fusion crystal • Stainless steel screw crown with etched Reserve logo • Genuine mother of pearl dial with applied ring • Date display
- Tritnite® luminous hands • 18kt rose gold plating

Band: High grade polyurethane strap in assorted colors with stainless steel metal inserts

- Stainless steel buckle with logo • 18kt rose gold plating

Water resistant: 500 meters

INVICTA

SPECIALTY SUBAQUA CHRONO MIDSIZE

Movement: Professional Swiss quartz chronograph

Case and dial: ø 44 mm • Solid stainless steel case with skeleton lugs • Reserve logo engraved on case side

- Stainless steel case back with fixed 6 screws • Flame fusion crystal • Stainless steel screw crown with etched Reserve logo • Genuine mother of pearl dial with applied ring • Date display
- Tritnite® luminous hands

Band: High grade polyurethane strap in assorted colors with stainless steel metal inserts

- Stainless steel buckle with logo

Water resistant: 500 meters



Model 0523
MOP



Model 0524
MOP



INVICTA RESERVE

FOR THE FEW WHO KNOW BEST

INVICTA

SPECIALTY RESERVE CHRONOGRAPH

Movement: Professional Swiss chronograph • 22 jewels

Case and dial: ø 53 mm • Solid stainless steel with skeleton lugs

- Textured or sunray dial with smoky-transparent eyes • Stainless steel case back • Flame fusion crystal
- Stainless steel crown with etched Reserve logo • Date display • Tritnite® luminous hands and indexes

- 18kt rose gold plating • Black ionic plating

Band: Solid stainless steel band with deployment buckle • Solid plate with Reserve logo

- 18kt rose gold plating • Black ionic plating

Water resistant: 500 meters



Model 5214

INVICTA

SPECIALTY RESERVE CHRONOGRAPH

Movement: Swiss chronograph • 22 jewels

Case and dial: ø 53 mm • Solid stainless steel with skeleton lugs

- Textured dial with smoky-transparent eyes • Stainless steel case back fixed • Flame fusion crystal
- Stainless steel crown with etched Reserve logo • Date display • Tritnite® luminous hands and indexes

- Black ionic plating • Ionic gun metal plating

Band: Solid stainless steel band with deployment buckle • Solid plate with Reserve logo

- Black ionic plating • Ionic gun metal plating

Water resistant: 500 meters



Model 6189



Model 5216

INVICTA

SPECIALTY RESERVE CHRONOGRAPH

Movement: Swiss chronograph • 22 jewels

Case and dial: ø 53 mm • Solid stainless steel with skeleton lugs • Reserve logo engraved on case side

• Textured or sunray dial with smoky-transparent eyes • Stainless steel case back fixed with 6 screws

• Flame fusion crystal • Stainless steel crown with etched Reserve logo • Date display

• Tritnite® luminous hands and indexes

Band: Solid stainless steel band with deployment buckle • Solid plate with Reserve logo

Water resistant: 500 meters



Model 5221



Model 5219



INVICTA

RESERVE

FOR THE FEW WHO KNOW BEST

INVICTA
SPECIALTY RESERVE MIDSIZE

Movement: Professional Swiss chronograph • 22 jewels

- Case and dial: ø 44 mm • Solid stainless steel case with skeleton lugs with etched logo on case side
- Stainless steel case back with screws • Flame fusion crystal • Textured dial with semi-transparent eyes
 - Stainless steel crown with etched Reserve logo • Date display • Tritnite® luminous hands and indexes
 - 18kt gold plating • 18kt rose gold plating • Black ionic plating

Band: Solid stainless steel band with stainless steel butterfly buckle and etched logo • 18kt gold plating • 18kt rose gold plating • Black ionic plating

Water resistant: 500 meters



Model 5658



Model 5656



Model 5657

INVICTA
SPECIALTY RESERVE MIDSIZE

Movement: Professional Swiss chronograph • 22 jewels

- Case and dial: ø 44 mm • Solid stainless steel case with skeleton lugs with etched logo on case side
- Stainless steel case back with screws • Flame fusion crystal • Textured dial with semi-transparent eyes
 - Stainless steel crown with etched Reserve logo • Date display • Tritnite® luminous hands and indexes
 - Black ionic plating

Band: Solid stainless steel band with stainless steel butterfly buckle and etched logo • Black ionic plating

Water resistant: 500 meters



Model 5655



Model 5659

INVICTA

RESERVE SUBAQUA GMT

Movement: Professional Swiss GMT quartz

Case and dial: ø 52 mm • Solid stainless steel with skeleton lugs • Reserve logo engraved on case side

• Stainless steel case back with fixed 6 screws • Flame fusion crystal

• Stainless steel crown with etched Reserve logo • Textured and sunray dial in assorted colors

• Date display • Tritnite® luminous hands and indexes • 18kt gold plating

Band: Black high grade polyurethane strap with stainless steel metal insert

• Stainless steel buckle with logo • 18kt gold plating

Water resistant: 500 meters



Model 6185



Model 6186



Model 6178



Model 6179



Model 6180

INVICTA

RESERVE SUBAQUA GMT

Movement: Professional Swiss GMT quartz

Case and dial: ø 52 mm • Solid stainless steel with skeleton lugs • Reserve logo engraved on case side

• Stainless steel case back with fixed 6 screws • Flame fusion crystal

• Stainless steel crown with etched Reserve logo • Textured and sunray dial in assorted colors

• Date display • Tritnite® luminous hands and indexes • 18kt rose gold plating • 18kt gold plating

Band: Black high grade polyurethane strap with stainless steel metal insert

• Stainless steel buckle with logo • 18kt rose gold plating • 18kt gold plating

Water resistant: 500 meters

INVICTA

RESERVE SUBAQUA GMT

Movement: Professional Swiss GMT quartz

Case and dial: ø 52 mm • Solid stainless steel with skeleton lugs • Reserve logo engraved on case side

• Stainless steel case back with fixed 6 screws • Flame fusion crystal

• Stainless steel crown with etched Reserve logo • Textured and sunray dial in assorted colors

• Date display • Tritnite® luminous hands and indexes • Black ionic plating • Ionic gun metal plating

Band: Black high grade polyurethane strap with stainless steel metal insert

• Stainless steel buckle with logo • Ionic gun metal plating

Water resistant: 500 meters



Model 6177



Model 6181



INVICTA

RESERVE

FOR THE FEW WHO KNOW BEST

INVICTA

RESERVE SUBAQUA VENOM STEEL

Movement: Professional Swiss 1/10 second chronograph

Case and dial: ø 53•7 mm • Solid stainless steel case • Unidirectional bezel with screws on side

- Screw down solid stainless steel case back • Stainless steel screw down crown with logo • Screw down pushers • Flame fusion crystal • Matte or sunray dial with inner ring • Dome shaped luminous dots • Date display • Tritnite® luminous hands • Black ionic plating • 18kt rose gold plating

Band: Solid stainless steel band with stainless steel buckle • 18kt rose gold plating • Black ionic plating • Gun ionic plating

Water resistant: 1000 meters



Model 5728



Model 5729



Model 5731

INVICTA

RESERVE SUBAQUA VENOM STEEL

Movement: Professional Swiss 1/10 second chronograph

Case and dial: ø 53•7 mm • Solid stainless steel case • Unidirectional bezel with screws on side

- Screw down solid stainless steel case back • Stainless steel screw down crown with logo • Screw down pushers • Flame fusion crystal • Matte or sunray dial with inner ring • Dome shaped luminous dots • Date display • Tritnite® luminous hands • Black ionic plating

Band: Solid stainless steel band with stainless steel buckle • Black ionic plating

Water resistant: 1000 meters



Model 5727



Model 5730

INVICTA

RESERVE SUBAQUA VENOM LEATHER

Movement: Professional Swiss quartz chronograph • 13 jewels

Case and dial: ø 53.7 mm • Solid stainless steel case • Unidirectional bezel with screws on side
• Stainless down solid stainless steel case back • Flame fusion crystal • Stainless steel screw crown with logo • Screw down pushers • Matte and semi-gloss dial with dome shape applied indexes

• Date display • Tritnite® luminous hands • 18kt rose gold plating

Band: Genuine leather strap in brown and black colors

• 18kt rose gold plating stainless steel buckle with etched logo

Water resistant: 1000 meters



Model 0359



Model 0360



INVICTA RESERVE

FOR THE FEW WHO KNOW BEST

INVICTA

RESERVE SUBAQUA VENOM

Movement: Professional Swiss quartz chronograph • 13 jewels

Case and dial: ø 53.7 mm • Solid stainless steel case • Unidirectional bezel with screws on side
 • Stainless down solid stainless steel case back • Flame fusion crystal • Stainless steel screw crown with logo
 • Screw down pushers • Carbon fiber dial in black color with dome shape applied indexes
 • Date display • Tritnite® luminous hands • 18kt rose gold plating • Ionic gun metal plating

Band: High grade polyurethane strap with stainless steel insets

• Stainless steel buckle with etched logo • 18kt rose gold plating • Ionic gun metal plating

Water resistant: 1000 meters



Model 0361

INVICTA

RESERVE SUBAQUA VENOM

Movement: Professional Swiss 1/10 second chronograph • 4 jewels

Case and dial: ø 53.7 mm • Solid stainless steel case • Unidirectional bezel with screws on side
 • Screw down solid stainless steel case back • Stainless steel screw down crown with logo
 • Screw down pushers • Flame fusion crystal • Matte dial with inner ring • Dome shaped luminous dots
 • Date display • Tritnite® luminous hands • 18kt rose gold plating • Black ionic plating

Band: Solid stainless steel band with stainless steel double push butterfly buckle

• 18kt rose gold plating • Black ionic plating

Water resistant: 1000 meters



Model 5733



Model 5732

INVICTA

RESERVE SUBAQUA VENOM

Movement: Professional Swiss 1/10 second chronograph • 4 jewels

Case and dial: ø 53•7 mm • Solid stainless steel case • Unidirectional bezel with screws on side

- Screw down solid stainless steel case back • Stainless steel screw down crown with logo
- Screw down pushers • Flame fusion crystal • Matte or sunray dials with inner ring in assorted colors
- Dome shaped luminous dots • Date display • Tritnite® luminous hands

- Black ionic plating • Gun ionic plating

Band: Solid stainless steel band with stainless steel double push butterfly buckle

- Gun ionic plating • Black ionic plating

Water resistant: 1000 meters



Model 6051



Model 5735



Model 5736

INVICTA

RESERVE SUBAQUA VENOM

Movement: Professional Swiss 1/10 second chronograph • 4 jewels

Case and dial: ø 53•7 mm • Solid stainless steel case • Unidirectional bezel with screws on side

- Screw down solid stainless steel case back • Stainless steel screw down crown with logo
- Screw down pushers • Flame fusion crystal • Sunray dial with inner ring in assorted colors
- Dome shape luminous dots • Date display • Tritnite® luminous hands

Band: High grade polyurethane strap with stainless steel metal inserts in assorted colors

- Stainless steel buckle with etched logo

Water resistant: 1000 meters



Model 6105



Model 6116

INVICTA

RESERVE NEKTON SPORT

Movement: Professional Swiss quartz chronograph with big date

Case and dial: ø 47 mm • Surgical grade solid stainless steel with unidirectional bezel • 18kt gold plating

• Flame fusion crystal • Solid stainless steel screw down case back • Stainless steel crown and pushers

with Reserve logo on the crown • Textured dials in assorted colors

• Tritnite® luminous indexes and hands • Big date display

Band: Surgical grade stainless steel band with push button deployment buckle with

machine cut texture on it • 18kt gold plating

Water resistant: 100 meters



Model 0761



Model 0760

INVICTA

RESERVE NEKTON SPORT

Movement: Professional Swiss quartz chronograph with big date

Case and dial: ø 47 mm • Surgical grade solid stainless steel with unidirectional bezel • Ionic black plating

• Flame fusion crystal • Solid stainless steel screw down case back • Stainless steel crown and pushers

with Reserve logo on the crown • Textured dials in assorted colors

• Tritnite® luminous indexes and hands • Big date display

Band: Surgical grade stainless steel band with push button deployment buckle with

machine cut texture on it • Ionic black plating

Water resistant: 100 meters



Model 0762



Model 0763

INVICTA

RESERVE NEKTON CHRONO

Movement: Professional Swiss made chronograph with big date

Case and dial: ø 53 mm • Surgical grade solid stainless steel

- Unidirectional bezel with embossed numerals • 18kt ionic gold plating • Flame fusion crystal
- Solid stainless steel screw down case back • Stainless steel screw down crown with Reserve logo etched on it • Screw down pushers • Sunray finish dials
- Tritnite® luminous indexes and hands • Day and date display

Band: Surgical grade stainless steel with center link in black polyurethane

- Solid diver buckle with safety lock • 18kt ionic gold plating • Ionic black plating

Water resistant: 200 meters



Model 0333

INVICTA

RESERVE NEKTON CHRONO

Movement: Professional Swiss made chronograph with big date

Case and dial: ø 53 mm • Surgical grade solid stainless steel

- Unidirectional bezel with embossed numerals • Ionic black plating • Flame fusion crystal
- Solid stainless steel screw down case back • Stainless steel screw down crown with Reserve logo etched on it • Screw down pushers • Matt/sunray finish dials
- Tritnite® luminous indexes and hands • Day and date display

Band: Surgical grade stainless steel with center link in black polyurethane

- Solid diver buckle with safety lock • Ionic black plating

Water resistant: 200 meters



Model 0334



Model 0329

INVICTA

RESERVE CAPSULE

Movement: Professional Swiss chronograph

Case and dial: ø 47.5 mm • Surgical grade solid stainless steel with textured finish on the case lugs

- Fixed top ring with polyurethane ring on outer edge • 18kt gold plating • Flame fusion crystal
- Solid stainless steel screw down case back
- Stainless steel screw down crown with Reserve logo etched on it • Screw down pushers
- Genuine mother of pearl dial with Tritnite® luminous indexes and hands • Day and date display

Band: Surgical grade stainless steel with center link in textured polyurethane

- Push button deployment buckle with machine cut texture on it • 18kt gold plating

Water resistant: 200 meters



Model 6662
MOP

Model 6663
MOP

INVICTA

RESERVE CAPSULE

Movement: Professional Swiss chronograph

Case and dial: ø 47.5 mm • Surgical grade solid stainless steel with textured finish on the case lugs

- Fixed top ring with polyurethane ring on outer edge • Black ionic plating • Flame fusion crystal
- Solid stainless steel screw down case back
- Stainless steel screw down crown with Reserve logo etched on it • Screw down pushers
- Genuine mother of pearl dial with Tritnite® luminous indexes and hands • Day and date display

Band: Surgical grade stainless steel with center link in textured polyurethane

- Push button deployment buckle with machine cut texture on it • Black ionic plating

Water resistant: 200 meters



Model 6664
MOP

Model 6661
MOP

INVICTA

RESERVE TONNEAU INTERCHANGEABLE

Movement: Professional Swiss chronograph

Case and dial: ø 48 mm • Surgical grade solid stainless steel case with special push button system for easy interchangeable band and leather strap • 18kt ionic gold plating • Flame fusion crystal

- Stainless steel case back fitted with 4 screws • Stainless steel / P.U. crown with Reserve logo etched on it • P.U. Pushers • Carbon fiber dials • Tritnite® luminous indexes and hands • Day and date display

Band: Surgical grade stainless steel with center link in textured polyurethane with solid divers buckle and safety clasp • 18kt ionic gold plating • Ionic black plating

Water resistant: 100 meters



Model 0745



INVICTA

RESERVE TONNEAU INTERCHANGEABLE

Movement: Professional Swiss chronograph

Case and dial: ø 48 mm • Surgical grade solid stainless steel case with special push button system for easy interchangeable band and leather strap • Ionic gun metal plating • Ionic black plating

- Flame fusion crystal • Stainless steel case back fitted with 4 screws • Stainless steel / P.U. crown with Reserve logo etched on it • P.U. Pushers • Carbon fiber dials • Tritnite® luminous indexes and hands • Day and date display

Band: Surgical grade stainless steel with center link in textured polyurethane with solid divers buckle and safety clasp • Ionic gun metal plating • Ionic black plating

Water resistant: 100 meters



Model 0746



Model 0747



INVICTA

RESERVE TONNEAU INTERCHANGEABLE

Movement: Professional Swiss chronograph

Case and dial: ø 48 mm • Surgical grade solid stainless steel case with special push button system for easy interchangeable band and leather strap • Ionic blue plating • Flame fusion crystal

- Stainless steel case back fitted with 4 screws • Stainless steel / P.U. crown with Reserve logo etched on it • P.U. Pushers • Carbon fiber dials • Tritnite® luminous indexes and hands • Day and date display

Band: Surgical grade stainless steel with center link in textured polyurethane with solid divers buckle and safety clasp • Ionic black plating • Ionic blue plating

Water resistant: 100 meters



Model 0744



Model 0748



INVICTA

EXCURSION RESERVE MULTIFUNCTION

Movement: Professional swiss quartz chronograph, 13 jewels

Case and dial: ø 50 mm • Solid stainless steel case with fixed bezel • Stainless steel screw down case back • Flame fusion crystal • Stainless steel screw crown • Irregular shape pushers

- Sunray dial in assorted colors • Date display • Tritnite® luminous hands and indexes • 18kt gold plating

Band: Solid stainless steel band with stainless steel diver buckle with safety lock • 18kt gold plating

Water resistant: 200 meters



Model 0206



Model 0205

INVICTA

EXCURSION RESERVE CHRONOGRAPH

Movement: Professional Swiss 1/10 second chronograph • 4 jewels

Case and dial: ø 53.5 mm • Solid stainless steel case with fixed bezel • Screw down stainless steel case back
• Flame fusion crystal • Stainless steel screw down crown with etched reserve logo • Irregular shape pushers
• Shiny genuine mother of pearl dial in assorted colors • Date display • Tritnite® luminous hands

Band: Solid stainless steel band with stainless steel diver buckle with safety lock

Water resistant: 200 meters



Model 6258
MOP



Model 6259
MOP

INVICTA

EXCURSION RESERVE CHRONOGRAPH

Movement: Professional Swiss 1/10 second chronograph • 4 jewels

Case and dial: ø 53.5 mm • Solid stainless steel case with fixed bezel • Screw down stainless steel case back
• Flame fusion crystal • Stainless steel screw down crown with etched reserve logo • Irregular shape pushers
• Sunray or matte dial in assorted colors • Date display • Tritnite® luminous hands • Black ionic plating

Band: Solid stainless steel band with stainless steel diver buckle with safety lock

• Black ionic plating **Water resistant:** 200 meters



Model 6260



Model 5677



Model 5675

INVICTA

EXCURSION RESERVE CHRONOGRAPH

Movement: Professional Swiss 1/10 second chronograph • 4 jewels

Case and dial: ø 53.5 mm • Solid stainless steel case with fixed bezel • Screw down stainless steel case back
• Flame fusion crystal • Stainless steel screw down crown with etched reserve logo • Irregular shap pushers

• Sunray dial in assorted colors • Date display • Tritnite® luminous hands • 18kt gold plating

Band: Solid stainless steel band with stainless steel diver buckle with safety lock • 18kt gold plating

Water resistant: 200 meters



Model 6261



Model 5676



Model 6256
MOP



Model 6257
MOP

INVICTA

EXCURSION RESERVE CHRONOGRAPH

Movement: Professional Swiss 1/10 second chronograph • 4 jewels

Case and dial: ø 53.5mm • Solid stainless steel case with fixed bezel • Screw down stainless steel case back
• Flame fusion crystal • Stainless steel screw down crown with etched reserve logo • Irregular shape pushers

• Shiny genuine mother of pearl dial in assorted colors • Date display • Tritnite® luminous hands

• 18kt gold plating

Band: Solid stainless steel band with stainless steel diver buckle with safety lock • 18kt gold plating

Water resistant: 200 meters

INVICTA

EXCURSION RESERVE QUARTZ

Movement: Professional Swiss quartz

Case and dial: ø 53.5 mm • Solid stainless steel case with fixed bezel • Stainless steel case back with screws
• Flame fusion crystal • Stainless steel screw down crown with etched reserve logo • Sunray dial or texture dial in assorted colors • Date display • Tritnite® luminous hands • 18kt gold plating • Black ionic plating

Band: Solid stainless steel band with stainless steel diver buckle with safety lock

• 18kt gold plating • Black ionic plating

Water resistant: 200 meters



Model 6248



Model 6251



Model 6250

INVICTA

EXCURSION RESERVE QUARTZ

Movement: Professional Swiss quartz

Case and dial: ø 53.5mm • Solid stainless steel case with fixed bezel • Stainless steel case back with screws
• Flame fusion crystal • Stainless steel screw down crown with etched reserve logo

• Genuine mother of pearl dial • Date display • Tritnite® luminous hands

Band: Solid stainless steel band with stainless steel diver buckle with safety lock

Water resistant: 200 meters



Model 6245
MOP



Model 6246
MOP

INVICTA

EXCURSION RESERVE QUARTZ

Movement: Professional Swiss made quartz

Case and dial: ø 53.5 mm • Solid stainless steel case with fixed bezel • Stainless steel case back with screws
• Flame fusion crystal • Stainless steel screw down crown with etched reserve logo • Genuine mother of
pearl dial in assorted colors • Date display • Tritnite® luminous hands • 18kt gold plating
Band: Solid stainless steel band with stainless steel diver buckle with safety lock • 18kt gold plating

Water resistant: 200 meters



Model 6243
MOP

Model 6244
MOP

INVICTA

EXCURSION RESERVE QUARTZ

Movement: Professional Swiss quartz

Case and dial: ø 53.5 mm • Solid stainless steel case with fixed bezel • Stainless steel case back with screws
• Flame fusion crystal • Stainless steel screw down crown with etched reserve logo
• Sunray dial in assorted colors • Date display • Tritnite® luminous hands • 18kt gold plating
Band: Solid stainless steel band with stainless steel diver buckle with safety lock • 18kt gold plating

Water resistant: 200 meters



Model 6247

Model 6249

INVICTA

EXCURSION RESERVE QUARTZ

Movement: Professional Swiss made quartz

Case and dial: ø 53.5 mm • Solid stainless steel case with fixed bezel • Stainless steel case back with screws
• Flame fusion crystal • Stainless steel screw down crown with etched Reserve logo • Sunray or enamel dial
in assorted colors • Date display • Tritnite® luminous hands and indexes

Band: Solid stainless steel band with stainless steel diver buckle with safety lock

Water resistant: 200 meters



Model 5672



Model 5673



Model 5674

INVICTA

EXCURSION RESERVE QUARTZ

Movement: Professional Swiss made quartz

Case and dial: ø 50 mm • Solid stainless steel with fixed bezel • Screw down stainless steel case back
• Flame fusion crystal • Genuine mother of pearl dial in light blue and black colors

• Stainless steel screw crown with etched Reserve logo • Date display • Tritnite® luminous hands

• Black ionic plating • Titanium ionic plating

Band: Solid stainless steel band with diver buckle with safety lock • Black ionic plating

• Titanium ionic plating

Water resistant: 200 meters



Model 0515
MOP



Model 0516
MOP

INVICTA

RESERVE EXCURSION FLEX

Movement: Professional Swiss 1/10 second chronograph • 4 jewels

Case and dial: ø 53.5 mm • Solid stainless steel case with fixed bezel • Stainless steel screw down case back
 • Flame fusion crystal • Stainless steel screw down crown with etched Reserve logo • Irregular shape pushers
 • Sunray and matte dial in assorted colors • Date display • Tritnite® luminous hands • 18kt gold plating

Band: High grade polyurethane strap in assorted colors with stainless steel metal inserts • Stainless steel buckle with logo • 18kt gold plating

Water resistant: 200 meters



Model 6266



Model 6267



Model 6268

INVICTA

RESERVE EXCURSION FLEX

Movement: Professional Swiss 1/10 second chronograph • 4 jewels

Case and dial: ø 53.5 mm • Solid stainless steel case with fixed bezel • Stainless steel screw down case back
 • Flame fusion crystal • Stainless steel screw down crown with etched Reserve logo • Irregular shape pushers • Sunray and matte dial in assorted colors • Date display
 • Tritnite® luminous hands

Band: High grade polyurethane strap in assorted colors with stainless steel metal inserts
 • Stainless steel buckle with logo

Water resistant: 200 meters



Model 6263



Model 6262

INVICTA

EXCURSION TOURING EDITION

Movement: Professional Swiss 1/10 sec • Chronograph

Case and dial: ø 52 mm • Solid stainless steel • Stainless steel screw down case back

- Unidirectional turning bezel • Flame fusion crystal • Sunray dial in assorted colors with applied rings
- Screw down crown • Date display • Tritnite® luminous hands • 18kt gold plating • Black ionic plating

Band: Solid stainless steel band with diver buckle and safety clasp with etched logo

- 18kt gold plating • Black ionic plating

Water resistant: 200 meters



Model 6469

Model 6471



Model 6474

INVICTA

EXCURSION TOURING EDITION

Movement: Professional Swiss made 1/10 sec • Chronograph

Case and dial: ø 52 mm • Solid stainless steel • Stainless steel screw down case back

- Unidirectional turning bezel • Flame fusion crystal • Sunray dial in assorted colors with applied rings
- Screw down crown • Date display • Tritnite® luminous hands

Band: Solid stainless steel band with diver buckle and safety clasp with etched logo

Water resistant: 200 meters



Model 5526

Model 5525

INVICTA

EXCURSION FLEX

Movement: Professional Swiss 1/10 sec chronograph

Case and dial: ø 52 mm • Solid stainless steel case • Stainless steel screw down case back
 • Unidirectional bezel • Flame fusion crystal • Stainless steel screw crown and pushers
 • Genuine mother of pearl dial with applied rings • Date display • Tritnite® luminous hands
 • 18kt gold plating

Band: High grade polyurethane strap with stainless steel metal inserts • 18kt gold plating

Water resistant: 200 meters

INVICTA

EXCURSION FLEX

Movement: Professional Swiss 1/10 sec chronograph

Case and dial: ø 52 mm • Solid stainless steel case • Stainless steel screw down case back
 • Unidirectional bezel • Flame fusion crystal • Stainless steel screw crown and pushers
 • Genuine mother of pearl dial with applied rings • Date display • Tritnite® luminous hands

Band: High grade polyurethane strap with stainless steel metal inserts

Water resistant: 200 meters



Model 6975
MOP



Model 6976
MOP



Model 6970
MOP



Model 6971
MOP

INVICTA

RESERVE DIVER

Movement: Swiss made automatic 26 jewels

- Case and dial:** ø 47 mm • Surgical grade solid stainless steel in combination brushed and shiny finish
- Unidirectional bezel • Ionic black plated with etched numerals and markers with super luminova
 - White super luminova glows light blue • Green super luminova glows green, Red super luminova glows red in darkness • Flame fusion crystal • Stainless steel exhibition case back fitted with 8 screws
 - Stainless steel screw down crown with Reserve logo etched on the crown • Sunray black dial
 - Super luminova indexes and hands • White super luminova glows light blue
 - Green super luminova glows green, Red super luminova glows red in darkness • Date display
- Band:** Surgical grade solid stainless steel with dual push button deployment buckle
- Solid plate with Invicta Reserve logo etched on it
- Water resistant:** 500 meters



Model 1019



Model 1018

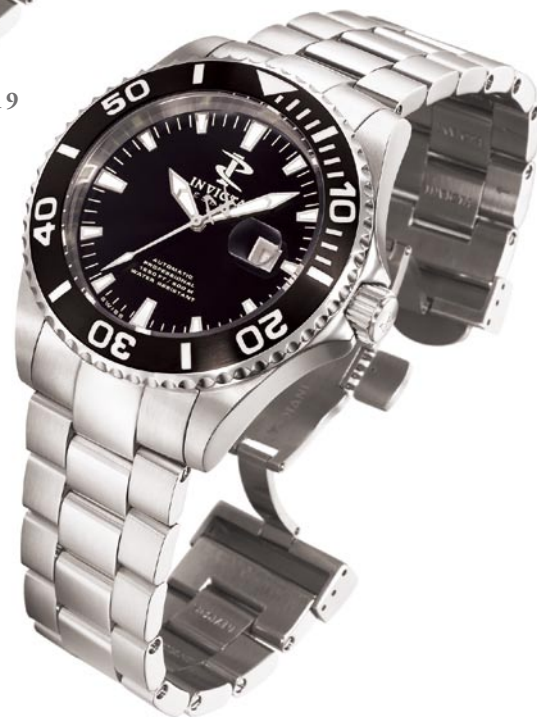

Model 1017

INVICTA

RESERVE DIVER CHRONO

Movement: Professional Swiss made chronograph

- Case and dial:** ø 47 mm • Surgical grade solid stainless steel in combination brush and shiny finish
- Unidirectional bezel • Ionic black plated with etched numerals and markers with Super luminova
 - White super luminova glows light blue • Green super luminova glows green • Red super luminova glows red in darkness • Flame fusion crystal • Stainless steel screw down case back fitted with 8 screws
 - Stainless steel screw down crown and pushers with Reserve logo etched on the crown • Sunray black dial
 - Super luminova indexes and hands • White super luminova glows light blue
 - Green super luminova glows green, Red super luminova glows red in darkness • Day and date display
- Band:** Surgical grade solid stainless steel with dual push button deployment buckle
- Solid plate with Invicta Reserve logo etched on it
- Water resistant:** 500 meters



Model 1022



Model 1021



Model 1020

INVICTA AKULA



RESERVE

FOR THE FEW WHO KNOW BEST

From out of Reserve, the vast power of the Invicta Akula demanded a collection all its own. This professional Swiss made chronograph is armed with 52mm solid stainless casing, date display, the engraved Reserve logo black ionic plating, and a flame fusion crystal to name but just a few of its attributes. The intensely popular Akula forged its mighty way forward loaded with the power and the looks to fully submerge you into the depths and caverns of your most bold mission.



INVICTA

AKULA RESERVE SPORT CHRONO

Movement: Professional Swiss made chronograph

Case and dial: ø 52 mm • Solid stainless steel case • Stainless steel screw down case back

- Flame fusion crystal • Sunray dial in assorted colors • Stainless steel crown with etched Reserve logo
- Stainless steel special engineered pushers • Date display • Tritnite® luminous indexes and hands
- Black ionic plating • 18kt rose gold plating

Band: High grade rubber strap in assorted colors • Stainless steel butterfly buckle with etched logo

• 18kt rose gold plating

Water resistant: 100 meters



Model 5277



Model 4843

INVICTA

AKULA RESERVE SPORT CHRONO

Movement: Professional Swiss made chronograph movement

Case and dial: ø 52mm • Solid stainless steel case • Stainless steel screw down case back

- Flame fusion crystal • Sunray or matte dials in assorted colors
- Stainless steel crown with etched Reserve logo • Stainless steel special engineered pushers
- Date display • Tritnite® luminous indexes and hands • Black ionic plating

Band: High grade rubber strap in assorted colors • Stainless steel butterfly buckle with etched logo

Water resistant: 100 meters



Model 4842



Model 5285

INVICTA

AKULA RESERVE BIG DATE GMT

- Movement:** Professional Swiss made GMT quartz with big date movement • 3 jewels
- Case and dial:** ø 52 mm • Solid stainless steel case with fixed bezel • Stainless steel screw down case back
- Flame fusion crystal • Special engineered pushers • Stainless steel crown with etched Reserve logo
 - Sunray or polished dial in assorted colors with applied ring • Tritnite® luminous hands and indexes
 - Date display • Black ionic plating • 18kt rose gold plating
- Band:** Black silicon strap • Stainless steel buckle with logo
- Water resistant:** 100 meters

INVICTA

AKULA RESERVE BIG DATE GMT

- Movement:** Professional Swiss made GMT quartz with big date movement • 3 jewels
- Case and dial:** ø 52 mm • Solid stainless steel case with fixed bezel • Stainless steel screw down case back
- Flame fusion crystal • Special engineered pushers • Stainless steel crown with etched Reserve logo
 - Sunray or polished dial in assorted colors with applied ring • Tritnite® luminous hands and indexes
 - Date display • Black ionic plating
- Band:** Black silicon strap • Stainless steel buckle with logo
- Water resistant:** 100 meters



Model 6428



Model 6430



Model 6431



Model 6427

INVICTA

AKULA RESERVE GMT MIDSIZE

- Movement: Professional Swiss made GMT quartz with big date movement • 3 jewels
- Case and dial: ø 44 mm • Solid stainless steel case with fixed bezel • Stainless steel screw down case back
- Flame fusion crystal • Special engineered pushers • Stainless steel crown with etched Reserve logo
 - Sunray or polished dial in assorted colors with applied ring • Tritnite® luminous hands and indexes
 - Date display • Black ionic plating • 18kt gold plating
- Band: Croco-pattern leather band in assorted colors with tone on tone fish-bone stitching
- Stainless steel buckle with logo
- Water resistant: 100 meters



Model 6445



Model 6446



Model 6447



INVICTA
AKULA
RESERVE
FOR THE FEW WHO KNOW BEST

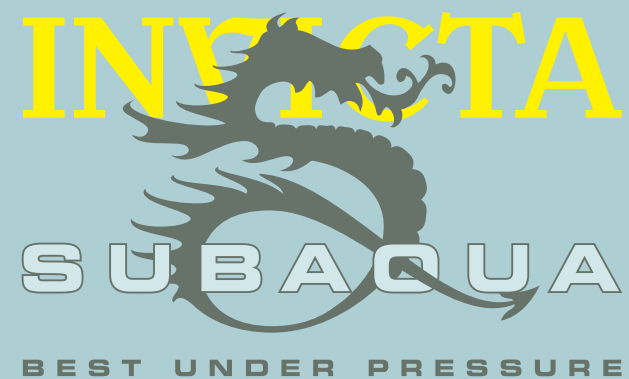

Led with expert engineering, and always ready to face the depths, no feat or occasion will ever be too great for Invicta's Subaqua to handle. The sheer magnitude of this mighty timepiece is superbly executed with surgical-grade solid stainless steel, Swiss automatic movements, and multiple color options of ionic plating. Managing up to 500 meters of water, finished off with a unidirectional rotating bezel, integrated shock resistance, and Invicta's luminous Tritnite® hands, the Subaqua is the diver's definitive in negotiating any adventure by sea or by land.



INVICTA

SUBAQUA NOMA IV CHRONO

Movement: Professional Swiss made quartz chronograph

Case and dial: ø 50 mm • Solid stainless steel case • Stainless steel screw down case back

- Unidirectional turning bezel • Flame fusion crystal • Cut through pattern dial with dome shape applied markers • Stainless steel screw down crown with protector with logo
- Stainless steel screw down pushers • Date display • Tritnite® luminous hands • 18kt gold plating • Black ionic plating

Band: Solid stainless steel band with diver buckle and safety lock • 18kt gold plating • Black ionic plating

Water resistant: 500 meters



Model 6553



Model 6561

INVICTA

SUBAQUA NOMA IV CHRONO

Movement: Professional Swiss made quartz chronograph

Case and dial: ø 50 mm • Solid stainless steel case • Stainless steel screw down case back

- Unidirectional turning bezel • Flame fusion crystal • Cut through pattern dial with dome shape applied markers • Stainless steel screw down crown with protector with logo
- Stainless steel screw down pushers • Date display • Tritnite® luminous hands • 18kt gold plating • 18kt rose gold plating • Black ionic plating

Band: Solid stainless steel band with diver buckle and safety lock • 18kt gold plating • 18kt rose gold plating • Black ionic plating

Water resistant: 500 meters



Model 6562



Model 6552

INVICTA

SUBAQUA NOMA IV CHRONO

Movement: Professional Swiss made quartz chronograph

Case and dial: ø 50 mm • Solid stainless steel case • Stainless steel screw down case back

- Unidirectional turning bezel • Flame fusion crystal • Cut through pattern dial with dome shape applied markers • Stainless steel screw down crown with protector with logo
- Stainless steel screw down pushers • Date display • Tritnite® luminous hands • Black ionic plating

Band: Solid stainless steel band with diver buckle and safety lock • Black ionic plating

Water resistant: 500 meters



Model 6546



Model 6548



Model 6550



Model 6551
Gun Metal

INVICTA

SUBAQUA NOMA IV CHRONO

Movement: Professional Swiss made quartz chronograph

Case and dial: ø 50 mm • Solid stainless steel case • Stainless steel screw down case back

- Unidirectional turning bezel • Flame fusion crystal • Cut through pattern dial with dome shape applied markers • Stainless steel screw down crown with protector with logo
- Stainless steel screw down pushers • Date display • Tritnite® luminous hands • Black ionic plating
- Ionic gun metal plating

Band: Solid stainless steel band with diver buckle and safety lock • Black ionic plating

Water resistant: 500 meters

INVICTA

SUBAQUA NOMA IV CHRONO

Movement: Professional Swiss made quartz chronograph

Case and dial: ø 50 mm • Solid stainless steel case • Stainless steel screw down case back

• Unidirectional turning bezel • Flame fusion crystal • Cut through pattern dial with dome shape applied markers • Stainless steel screw down crown with protector with logo

• Stainless steel screw down pushers • Date display • Tritnite® luminous hands

Band: Solid stainless steel band with diver buckle and safety lock

Water resistant: 500 meters



Model 6555



Model 6556



INVICTA
SUBAQUA
BEST UNDER PRESSURE

INVICTA

SUBAQUA NOMA IV CHRONO

Movement: Professional Swiss made quartz chronograph

Case and dial: ø 50 mm • Solid stainless steel case • Stainless steel screw down case back

- Unidirectional turning bezel • Flame fusion crystal • Cut through pattern dial with dome shape applied markers • Stainless steel screw down crown with protector with logo
- Stainless steel screw down pushers • Date display • Tritnite® luminous hands • 18kt gold plating
- 18kt rose gold plating • Black ionic plating

Band: High grade polyurethane band in black color with stainless steel metal inserts

- Stainless steel buckle with logo • 18kt gold plating • 18kt rose gold plating • Black ionic plating

Water resistant: 500 meters



Model 6575



Model 6583



Model 6582



Model 6576

INVICTA

SUBAQUA NOMA IV CHRONO

Movement: Professional Swiss made quartz chronograph movement

Case and dial: ø 50 mm • Solid stainless steel case • Stainless steel screw down case back

- Unidirectional turning bezel • Flame fusion crystal • Cut through pattern dial with dome shape applied markers • Stainless steel screw down crown with protector with logo
- Stainless steel screw down pushers • Date display • Tritnite® luminous hands • Black ionic plating

Band: High grade polyurethane band in black color with stainless steel metal inserts

- Stainless steel buckle with logo • Black ionic plating

Water resistant: 500 meters

INVICTA

SUBAQUA NOMA IV CHRONO

Movement: Professional Swiss made quartz chronograph

Case and dial: ø 50 mm • Solid stainless steel case • Stainless steel screw down case back

- Unidirectional turning bezel • Flame fusion crystal • Cut through pattern dial with dome shape applied markers • Stainless steel screw down crown with protector with logo
- Stainless steel screwdown pushers • Date display • Tritnite® luminous hands • Black ionic plating

Band: High grade polyurethane band in black color with stainless steel metal inserts

- Stainless steel buckle with logo • Black ionic plating

Water resistant: 500 meters



Model 6564



Model 6565



Model 6566

INVICTA

SUBAQUA NOMA IV CHRONO

Movement: Professional Swiss made quartz chronograph

Case and dial: ø 50 mm • Solid stainless steel case • Stainless steel screw down case back

- Unidirectional turning bezel • Flame fusion crystal • Cut through pattern dial with dome shape applied markers • Stainless steel screw down crown with protector with logo
- Stainless steel screwdown pushers • Date display • Tritnite® luminous hands • Black ionic plating

Band: High grade polyurethane band in black color with stainless steel metal inserts

- Stainless steel buckle with logo • Black ionic plating

Water resistant: 500 meters



Model 6567



Model 6568



Model 6569

INVICTA

SUBAQUA NOMA IV CHRONO

Movement: Professional Swiss made quartz chronograph

Case and dial: ø 45 mm • Solid stainless steel case • Stainless steel screw down case back

- Unidirectional rotating bezel • Flame fusion crystal • Sunray dial in black color with stamp and cut through pattern • Stainless steel screw crown with protector • Date display
- Tritnite® luminous hands and indexes • Black ionic plating

Band: High grade polyurethane strap in black color with stainless steel metal inserts

- Stainless steel buckle with etched logo • Black ionic plating

Water resistant: 500 meters



Model 0520

INVICTA

SUBAQUA NOMA IV AUTOMATIC

Movement: Professional Swiss made SW200 automatic • 26 jewels • Shock resistant 28,800vph

Case and dial: ø 45 mm • Solid stainless steel case • Stainless steel exhibition case back

- Unidirectional rotating bezel • Flame fusion crystal • Sunray dial in black color with stamp and cut through pattern • Stainless steel screw crown with protector • Date display
- Tritnite® luminous hands and indexes • Black ionic plating

Band: High grade polyurethane strap with stainless steel metal inserts

- Stainless steel buckle with etched logo • Black ionic plating

Water resistant: 500 meters



Model 0521



Model 0522



Case Back

INVICTA

LADY SUBAQUA NOMA IV CHRONO

Movement: Professional Swiss made quartz chronograph

Case and dial: ø 40 mm • Solid stainless steel case • Stainless steel screw down case back

- Unidirectional rotating bezel • Flame fusion crystal • Genuine mother of pearl dial
- Stainless steel screw down crown with protector • Date display • Tritnite® luminous hands and indexes
- Black ionic plating • 18kt gold plating • 18kt rose gold plating

Band: High grade polyurethane strap with stainless steel metal insets

- Stainless steel buckle with etched logo • 18kt gold plating • 18kt rose gold plating

Water resistant: 500 meters



Model 0536
MOP



Model 0537
MOP



Model 0535
MOP



Model 0540
MOP



Model 0541
MOP



Model 0538
MOP



Model 0539
MOP

INVICTA

LADY SUBAQUA NOMA IV AUTOMATIC

Movement: Professional Swiss made quartz

Case and dial: ø 40 mm • Solid stainless steel case • Stainless steel screw down case back

- Unidirectional rotating bezel • Flame fusion crystal • Genuine mother of pearl dial
- Stainless steel screw down crown with protector • Date display • Tritnite® luminous hands and indexes
- Black ionic plating • 18kt gold plating • 18kt rose gold plating

Band: High grade polyurethane strap with stainless steel metal insets

- Stainless steel buckle with etched logo • 18kt gold plating • 18kt rose gold plating

Water resistant: 500 meters

INVICTA

SUBAQUA NITRO INTERCHANGEABLE

Movement: Professional Swiss made quartz chronograph • 13 jewels

Case and dial: ø 50 mm • Solid stainless steel case • Unidirectional plastic turning bezel

- Solid stainless steel screw down case back • Flame fusion crystal • Stainless steel screw crown and pushers
- Sunray and brushed dial in assorted colors with dome shape applied indexes • Date display
- Tritnite® luminous hands • 18kt gold plating • Black ionic plating

Band: Solid stainless steel band with polyurethane links • 2pcs polyurethane rotated links on end piece in black colors • Stainless steel diver buckle with safety lock • 18kt gold plating • Black ionic plating

Water resistant: 100 meters



Model 0403



Model 0402



Model 0406

INVICTA

SUBAQUA NITRO INTERCHANGEABLE

Movement: Professional Swiss made quartz chronograph • 13 jewels

Case and dial: ø 50 mm • Solid stainless steel case • Unidirectional plastic turning bezel

- Solid stainless steel screw down case back • Flame fusion crystal • Stainless steel screw crown and pushers
- Sunray and brushed dial in assorted colors with dome shape applied indexes • Date display
- Tritnite® luminous hands • 18kt rose gold plating • Black ionic plating

Band: Solid stainless steel band with polyurethane links • 2pcs polyurethane rotated links on end piece in black colors • Stainless steel diver buckle with safety lock • 18kt rose gold plating

• Black ionic plating

Water resistant: 100 meters



Model 0405



Model 0404

INVICTA

SUBAQUA NITRO INTERCHANGEABLE

Movement: Professional Swiss made quartz chronograph • 13 jewels

Case and dial: ø 50 mm • Solid stainless steel screw crown and pushers

- Sunray and brushed dial in assorted colors with dome shape applied indexes • Date display
- Tritnite® luminous hands • 18kt rose gold plating • 18kt gold plating • Black ionic plating

Band: High grade polyurethane strap with 2 pcs stainless steel rotated links on end piece

- Stainless steel buckle • 18kt rose gold plating • 18kt gold plating • Black ionic plating

Water resistant: 100 meters



Model 0654



Model 0655



Model 0656



Model 0653

INVICTA

SUBAQUA NITRO INTERCHANGEABLE

Movement: Professional Swiss made quartz chronograph • 13 jewels

Case and dial: ø 50 mm • Solid stainless steel screw crown and pushers

- Sunray and brushed dial in assorted colors with dome shape applied indexes • Date display
- Tritnite® luminous hands • Black ionic plating

Band: High grade polyurethane strap with 2 pcs stainless steel rotated links on end piece

- Stainless steel buckle • Black ionic plating

Water resistant: 100 meters

INVICTA

SUBAQUA NOMA III CHRONO STEEL CHRONOGRAPH

Movement: Swiss made 1/10 second chronograph • 13 jewels

Case and dial: ø 50 mm • Solid stainless steel case • Stainless steel screw down case back

- Unidirectional rotating bezel • Flame fusion crystal • Sunray double layered dial in assorted colors
 - Screw down crown with protector • Screw down pushers • Day and date display
 - Tritnite® luminous hands • 18kt gold plating

Band: Solid stainless steel band with diver buckle and safety clasp • 18kt gold plating

Water resistant: 500 meters



Model 5403



Model 5404



Model 5405



Model 5406

INVICTA

SUBAQUA NOMA III CHRONO STEEL CHRONOGRAPH

Movement: Swiss made 1/10 second chronograph • 13 jewels

Case and dial: ø 50 mm • Solid stainless steel • Stainless steel screw down case back

- Unidirectional rotating bezel • Flame fusion crystal • Sunray double layered dial in assorted colors
 - Screw down crown with protector • Screw down pushers • Day and date display
 - Tritnite® luminous hands • 18kt gold plating

Band: Solid stainless steel band with diver stainless steel buckle and safety clasp • 18kt gold plating

Water resistant: 500 meters

INVICTA

SUBAQUA NOMA III CHRONO STEEL CHRONOGRAPH

Movement: Professional Swiss chronograph • 13 jewels

Case and dial: ø 50 mm • Solid stainless steel case • Stainless steel screw down case back

- Unidirectional rotating bezel • Flame fusion crystal • Matte black dial
- Screw down crown with protector • Screw down pushers • Date and day display
- Tritnite® luminous hands • 18kt gold plating • 18kt rose gold plating

Band: Stainless steel band with diver buckle and safety clasp • 18kt gold plating

- 18kt rose gold plating
- **Water resistant:** 500 meters



Model 4697



Model 4698



Model 4695



Model 4696

INVICTA

SUBAQUA NOMA III CHRONO STEEL CHRONOGRAPH

Movement: Professional Swiss chronograph • 13 jewels

Case and dial: ø 50 mm • Solid stainless steel case • Stainless steel screw down case back

- Unidirectional rotating bezel • Flame fusion crystal • Matte black dial
- Screw down crown with protector • Screw down pushers • Date and day display
- Tritnite® luminous hands • Black ionic plating

Band: Stainless steel band with diver buckle and safety clasp • Black ionic plating

Water resistant: 500 meters

INVICTA
SUBAQUA CHRONOGRAPH

Movement: Professional Swiss chronograph

Case and dial: ø 50 mm • Solid stainless steel case • Stainless steel screw down case back

- Unidirectional rotating bezel • Flame fusion crystal • Mother of pearl dial
- Screw down crown and pushers • Date display • Tritnite® luminous hands

Band: Stainless steel band with diver buckle and safety clasp

Water resistant: 500 meters



Model 4568
MOP

Model 4574
MOP

Model 4571
MOP

INVICTA
SUBAQUA CHRONOGRAPH

Movement: Professional Swiss chronograph

Case and dial: ø 50 mm • Solid stainless steel case • Stainless steel screw down case back

- Unidirectional rotating bezel • Flame fusion crystal • Sunray dial • Screw down crown and pushers
- Date display • Tritnite® luminous hands

Band: Stainless steel band with diver buckle and safety clasp

Water resistant: 500 meters



Model 4566
Sunray

Model 4572
Sunray

Model 4569
Sunray

INVICTA

SUBAQUA NOMA III FLEX

Movement: Professional Swiss made chronograph

Case and dial: ø 50 mm • Solid stainless steel case • Stainless steel screw down case back • Unidirectional rotating bezel • Flame fusion crystal • Sunray double layered dial in assorted colors • Screw down crown with protector • Screw down pushers • Date display • Tritnite® luminous hands • 18kt gold plating

Band: High grade polyurethane strap with stainless steel metal inserts

- Stainless steel buckle with etched logo • 18kt gold plating

Water resistant: 500 meters



Model 5514



Model 5517



Model 5516



Model 5515

INVICTA

SUBAQUA NOMA III FLEX

Movement: Professional Swiss made chronograph

Case and dial: ø 50 mm • Solid stainless steel case • Stainless steel screw down case back • Unidirectional rotating bezel • Flame fusion crystal • Sunray double layered dial in assorted colors • Screw down crown with protector • Screw down pushers • Date display • Tritnite® luminous hands • Ionic gun metal plating

Band: High grade polyurethane strap with stainless steel metal inserts

- Stainless steel buckle with etched logo • Ionic gun metal plating • 18kt rose gold plating

Water resistant: 500 meters



Model 5508



Model 5509



Model 5510

INVICTA

SUBAQUA NOMA III FLEX

Movement: Professional Swiss made chronograph

Case and dial: ø 50 mm • Solid stainless steel case • Stainless steel screw down case back

- Unidirectional rotating bezel • Flame fusion crystal • Sunray double layered dial in assorted colors
- Screw down crown with protector • Screw down pushers • Date display • Tritnite® luminous hands

Band: High grade polyurethane strap with stainless steel metal inserts

- Stainless steel buckle with etched logo

Water resistant: 500 meters



Model 5513



Model 5511



Model 5512



INVICTA
SUBAQUA
 BEST UNDER PRESSURE

INVICTA

SUBAQUA NOMA III GMT FLEX

Movement: Professional Swiss made GMT quartz movement

Case and dial: ø 50 mm • Solid stainless steel case • Screw down stainless steel case back

- Unidirectional rotating bezel • Flame fusion crystal • Genuine mother of pearl dial in assorted colors
- Stainless steel screw crown with protector • Date display • Tritnite® luminous hands and indexes
- 18kt gold plating • 18kt rose gold plating

Band: High grade poluurethane strap with stainless steel metal inserts

- Stainless steel buckle with etched logo • 18kt gold plating • 18kt rose gold plating

Water resistant: 500 meters



Model 0738
MOP



Model 0739
MOP

INVICTA

SUBAQUA NOMA III GMT FLEX

Movement: Professional Swiss made GMT quartz movement

Case and dial: ø 50 mm • Solid stainless steel case • Screw down stainless steel case back

- Unidirectional rotating bezel • Flame fusion crystal • Genuine mother of pearl dial in assorted colors
- Stainless steel screw crown with protector • Date display • Tritnite® luminous hands and indexes
- Black ionic plating • Ionic gun metal plating

Band: High grade poluurethane strap with stainless steel metal inserts

- Stainless steel buckle with etched logo • Black ionic plating • Ionic gun metal plating

Water resistant: 500 meters



Model 0736
MOP



Model 0740
MOP



Model 0737
MOP

INVICTA

SUBAQUA NOMA III GMT FLEX

Movement: Professional Swiss made GMT quartz

Case and dial: ø 50 mm • Solid stainless steel case in titanium color • Screw down stainless steel case back

- Unidirectional rotating bezel • Flame fusion crystal • Textured dial in titanium color
- Stainless steel screw crown with protector • Date display • Tritnite® luminous hands and indexes

Band: High grade polyurethane strap with stainless steel metal inserts in titanium color

- Stainless steel buckle in titanium color with etched logo

Water resistant: 500 meters



Model 0781



INVICTA
SUBAQUA
BEST UNDER PRESSURE

INVICTA

SUBAQUA NOMA III GMT FLEX

Movement: Professional Swiss made GMT quartz movement

Case and dial: ø 50 mm • Solid stainless steel case • Screw down stainless steel case back

- Unidirectional rotating bezel • Flame fusion crystal • Sunray and textured dial in assorted colors
- Stainless steel screw down crown with protector • Date display • Tritnite® luminous hands and indexes
- Black ionic plating

Band: High grade polyurethane strap with stainless steel metal inserts

- Stainless steel buckle with etched logo

Water resistant: 500 meters



Model 0777



Model 0778



Model 0779



Model 0780

INVICTA

SUBAQUA NOMA III GMT FLEX

Movement: Professional Swiss made GMT quartz movement

Case and dial: ø 50 mm • Solid stainless steel case • Screw down stainless steel case back

- Unidirectional rotating bezel • Flame fusion crystal • Sunray and textured dial in assorted colors
- Stainless steel screw down crown with protector • Date display • Tritnite® luminous hands and indexes
- Black ionic plating

Band: High grade polyurethane strap with stainless steel metal inserts

- Stainless steel buckle with etched logo

Water resistant: 500 meters

INVICTA
luminary
COLLECTION
IMPARTING INNER LIGHT

An external glow reflects complex internal brilliance throughout the Invicta Luminary Collection. In the wake of any circumstance, take charge with a watch of substance. Emphasizing dynamic power, the pieces of Luminary offer layers of intricate and purposeful timekeeping complete with incandescent illumination to be guided by. Capture the brightest technology and become a Luminary.



INVICTA

LUMINARY SPORT

Movement: Professional Swiss made chronograph

Case and dial: ø 52 mm • Surgical grade solid stainless steel case with unidirectional rotating bezel
 • Flame fusion crystal • Stainless steel screw down case back • Stainless steel crown and pushers
 • Sunray dials • Indexes and hands with mb-Microtec H3 (luminous tubes) • Day and date display

Band: Surgical grade stainless steel band with solid diver buckle and safety clasp

Water resistant: 100 meters

INVICTA

LUMINARY SPORT

Movement: Professional Swiss made chronograph

Case and dial: ø 52 mm • Surgical grade solid stainless steel case with unidirectional rotating bezel
 • Ionic black plating • Flame fusion crystal • Stainless steel screw down case back
 • Stainless steel crown and pushers • Sunray dial
 • Indexes and hands with mb-Microtec H3 (luminous tubes) • Day and date display

Band: Surgical grade stainless steel band with solid diver buckle and safety clasp • Ionic black plating

Water resistant: 100 meters



Model 0356
Luminary Tubes



Model 0357
Luminary Tubes



Model 0358
Luminary Tubes

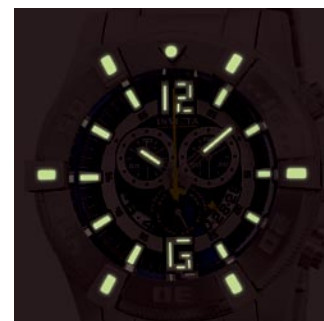

Luminary Effect



Luminary Effect



INVICTA SEASPIDER COLLECTION

ACCURATE TIME WEAVERS

Invicta's Swiss Chronograph Sea Spider is all manmade muscle. Invicta has taken the best and most ingenious of mechanisms and woven a brilliant web of endurance for the most active of ladies and gents. The young spirit of Sea Spider was spun out of the Specialty collection with meticulous precision boasting bold 50mm faces, stainless steel casing, opaque date window and a variety of metal finish combinations.

The uniquely constructed polyurethane band is linked together with stainless steel pins offering secure flexibility. With an array of vibrant colors to match the stamina and dexterity of any sport, the Sea Spider is lightweight enough to make you a heavyweight in any rugged realm of play.



INVICTA

CHRONOGRAPH XL SPECIAL SPIDER EDITION

Movement: Professional Swiss made chronograph • 12 jewels

Case and dial: ø 55 mm • Solid stainless steel case with fixed bezel • Stainless steel screw down case back
• Rounded polyurethane pushers • Flame fusion crystal • Double layered black dial with semi-transparent center • Date display • Tritnite® luminous hands • Black ionic plating

Band: Ultra light thermopolymer band in black with solid stainless steel pins • Black ionic plating

Water resistant: 200 meters



Model 5914
Black Spider Special Edition

Model 5915
Red Spider Special Edition

INVICTA

SEA SPIDER CHRONOGRAPH XL

Movement: Professional Swiss made chronograph movement • 13 jewels

Case and dial: ø 55 mm • Solid stainless steel case with fixed bezel • Stainless steel screw down case back
• Rounded polyurethane pushers • Flame fusion crystal • Double layered dial in assorted colors with semi-transparent center • Date display • Tritnite® luminous hands • 18kt gold plating

Band: Ultra light thermopolymer band in assorted colors with solid stainless steel pins • Stainless steel diver buckle with safety lock • 18kt gold plating

Water resistant: 200 meters



Model 6479

Model 6480

INVICTA

SEA SPIDER CHRONOGRAPH XL

Movement: Professional Swiss made chronograph • 12 jewels

Case and dial: ø 55 mm • Solid stainless steel case with fixed bezel • Stainless steel screw down case back

- Rounded polyurethane pushers • Flame fusion crystal • Double layered dial in assorted colors with semi-transparent center • Date display • Tritnite® luminous hands • 18kt rose gold plating

Band: Ultra light thermopolymer band in assorted colors with solid stainless steel pins

- 18kt rose gold plating

Water resistant: 200 meters



Model 5538



Model 5539

INVICTA

SEA SPIDER CHRONOGRAPH XL

Movement: Professional Swiss made chronograph • 12 jewels

Case and dial: ø 55 mm • Solid stainless steel case with fixed bezel • Stainless steel screw down case back

- Rounded polyurethane pushers • Flame fusion crystal • Double layered dial in assorted colors with semi-transparent center • Date display • Tritnite® luminous hands • Black ionic plating

Band: Ultra light thermopolymer band in assorted colors with solid stainless steel pins

- Black ionic plating

Water resistant: 200 meters



Model 5535



Model 5536

INVICTA

SEA SPIDER CHRONOGRAPH XL

Movement: Professional Swiss made chronograph • 12 jewels

Case and dial: ø 55 mm • Solid stainless steel case with fixed bezel • Stainless steel screw down case back

• Rounded polyurethane pushers • Flame fusion crystal • Double layered dial in assorted colors with semi-transparent center • Date display • Tritnite® luminous hands

Band: Ultra light thermopolymer band in assorted colors with solid stainless steel pins

Water resistant: 200 meters



Model 5532



Model 5534



INVICTA
SEASPIDER
COLLECTION

ACCURATE TIME WEAVERS



Originally created to honor the 1959 watch commissioned by the Russian Naval Fleet, Invicta's Russian Diver commands attention. Strikingly oversized with its complementing Signature crown cap and surgical stainless steel or titanium construction, the truly bold Russian Diver proudly possesses the distinction of being Invicta's largest timepiece. Yet, evolving to accommodate demand, these patented designs now include models fit for any woman's bidding. Equally comfortable scaling the heights of adventure or arriving for dinner, this Russian Diver will never be in doubt and always able to fulfill the orders of any mission.



INVICTA

RESERVE RUSSIAN DIVER INTERCHANGEABLE

Movement: Professional Swiss made GMT quartz movement

Case and dial: ø 50 mm • Solid stainless steel case with stainless steel chain and crown protector
• Stainless steel case back with screws • Flame fusion crystal • Sunray dial in silver and black colors

• Screw down crown • Date display • Tritnite® luminous hands • 18kt rose gold plating

Band: High grade polyurethane strap in black color • Stainless steel buckle with logo

• Extra 4pcs stainless steel for interchangeable device

Extra band: Genuine leather strap with cross pattern with stainles steel buckle

Extra band: Solid stainless steel band with diver buckle and safety lock

Water resistant: 100 meters



Model 0235



Model 0233



Model 0234

INVICTA



Model 0233
LEATHER



Model 0234
LEATHER



Model 0235
LEATHER



Model 0233 - 0235
RUBBER

INVICTA

RUSSIAN DIVER SPORT CHRONO

Movement: Professional Swiss quartz chronograph movement

Case and dial: ø 52 mm • Solid stainless steel case • Solid stainless steel case with matt blue rubber with crown protective cap • Stainless steel screw up case back • Fixed bezel with stainless steel stands
• Flame fusion crystal • Special screw in crown protective cap • Black dial in wrinkle pattern with applied ring • Textured dial in black color with cut through text inner ring • Date display
• Tritnite® luminous hands • Black ionic plating

Band: Polyurethane band in black color with stainless steel cylinder tubes and stainless steel metal inserts
• Stainless steel buckle with etch logo • Black ionic plating

Water resistant: 100 meters



Model 0517



Model 0518

INVICTA

RUSSIAN DIVER SPORT GMT

Movement: Professional Swiss made GMT movement

Case and dial: ø 52 mm • Solid stainless steel case with matt black rubber • Stainless steel screw up case back • Fixed bezel with rubber stands • Flame fusion crystal • Special screw in crown protective cap
• Sunray dial in assorted color with applied frame • Date display • Black dial in wrinkle pattern with applied frame • Date display • Tritnite® luminous hands

Band: Polyurethane band in assorted colors with stainless steel cylinder tubes and stainless steel metal inserts • Stainless steel buckle with etch logo

Water resistant: 100 meters



Model 0364



Model 0363



Model 0362

INVICTA

QUINOTAUR RUSSIAN DIVER CHRONOGRAPH

Movement: Professional Swiss chronograph

Case and dial: ø 51.5mm • Solid stainless steel • Stainless steel screw down case back

• Screw down crown with protective cap • Matte dial in assorted colors • Surgical grade solid stainless steel case • Flame fusion crystal • Sunray dial • Date display • Tritnite® luminous hands

Band: Rubber strap in assorted colors with stainless steel barrel insets

• High grade polyurethane strap with stainless steel metal inserts

Water resistant: 100 meters



Model 4578



Model 4580



Model 0246



 **INVICTA**
RUSSIAN
1959 DIVER
SINCE 1959
BETWEEN THE DEVIL AND THE DEEP BLUE SEA
COME HELL OR HIGH WATER



GOING THE DISTANCE

The S1 Rally is waiting to be taken out for a serious spin. At Invicta we know to cruise in the fast lane means to live in a world where a moment in time can determine ultimate glory. Look no further than an S1 timepiece to mark each second with precise perfection. This fully developed racing series is emboldened by features including Swiss movements, stainless steel casing, colored hands and textured dials. The deft S1 Rally will clock life's mileage both off and on the track.



INVICTA

S1 TOURING EDITION

- Movement:** Professional Swiss made chronograph movement • 6 jewels
- Case and dial:** ø 48mm • Solid stainless steel case • Stainless steel case back with screws
- Flame fusion crystal • Double layered polished and carbon fiber dial in assorted colors • Stainless steel crown with etched logo • Stainless steel special engineered pushers • Date display
 - Tritnite® luminous hands • 18kt gold plating
- Band:** Black bufalino leather strap with diamond shape stitching pattern
- Stainless steel butterfly buckle with etched logo
- Water resistant:** 100 meters



Model 5662



Model 5663

INVICTA

S1 TOURING EDITION

- Movement:** Professional Swiss made chronograph movement • 6 jewels
- Case and dial:** ø 48mm • Solid stainless steel case • Stainless steel case back with screws
- Flame fusion crystal • Double layered polished and carbon fiber dial in black colors • Stainless steel crown with etched logo • Stainless steel special engineered pushers • Date display
 - Tritnite® luminous hands • Black ionic plating
- Band:** Black bufalino leather strap with diamond shape stitching pattern
- Stainless steel butterfly buckle with etched logo
- Water resistant:** 100 meters



Model 5401

INVICTA

S1 TOURING EDITION

- Movement:** Professional Swiss made chronograph movement • 6 jewels
- Case and dial:** ø 48mm • Solid stainless steel case • Stainless steel case back with screws
- Flame fusion crystal • Double layered polished and carbon fiber dial in silver colors • Stainless steel crown with etched logo • Stainless steel special engineered pushers • Date display
 - Tritnite® luminous hands • 18kt rose gold plating
- Band:** Black and brown bufalino leather strap with diamond shape stitching pattern
- Stainless steel butterfly buckle with etched logo
- Water resistant:** 100 meters



Model 5402



Model 5660



GOING THE DISTANCE

INVICTA

S1 SPORT CHRONO RETROGRADE

Movement: Professional Swiss made retro-grade chronograph quartz movement • 6 jewels

Case and dial: ø 52 mm • Solid stainless steel case with screws on top • Stainless steel screw up case back

• Flame fusion crystal • Stainless steel crown and pushers with etch pattern

• Matt/sunray dials with applied ring with luminous in assorted colors • Date display

• Tritnite® luminous hands • 18kt gold plating • 18kt rose gold plating

Band: Black rubber band extended to case lugs • Stainless steel buckle w/etch logo

Water resistant: 100 meters



Model 5689



Model 5688



GOING THE DISTANCE

INVICTA

S1 SPORT CHRONO

- Movement:** Professional Swiss made chronograph quartz movement with big date • 3 jewels
- Case and dial:** ø 52 mm • Solid stainless steel case • Screw down stainless steel case back
- Flame fusion crystal • Stainless steel crown with etched logo
- Stainless steel special engineered pushers • Enamel sunray dial in assorted colors • Date display
- Tritnite® luminous hands • 18kt gold plating • 18kt rose gold plating
- Band:** High grade polyurethane band with stainless steel buckle with etched logo
- Water resistant:** 100 meters



Model 6493



Model 6483



Model 6490
MOP



Model 6491
MOP

INVICTA

S1 SPORT CHRONO

- Movement:** Professional Swiss made chronograph quartz movement with big date • 3 jewels
- Case and dial:** ø 52 mm • Solid stainless steel case • Screw down stainless steel case back
- Flame fusion crystal • Stainless steel crown with etched logo • Stainless steel special engineered pushers
 - Genuine mother of pearl dial • Date display • Tritnite® luminous hands
- Band:** High grade polyurethane band with stainless steel buckle with etched logo
- Water resistant:** 100 meters

INVICTA
S1 SPORT CHRONO

- Movement:** Professional Swiss made chronograph quartz movement with big date • 3 jewels
- Case and dial:** ø 52 mm • Solid stainless steel case • Screw down stainless steel case back
- Flame fusion crystal • Stainless steel crown with etched logo • Stainless steel special engineered pushers
 - Enamel sunray dial in assorted colors • Date display • Tritnite® luminous hands
- Band:** High grade polyurethane band with stainless steel buckle with etched logo
- Water resistant:** 100 meters



Model 6488



Model 6489

INVICTA
S1 SPORT CHRONO

- Movement:** Professional Swiss made GMT quartz
- Case and dial:** ø 52 mm • Solid stainless steel case with screws on top • Stainless steel screw down case back • Flame fusion crystal • Carbon fiber dial in black color with transparent plastic plate
- Stainless steel crown with etched logo • Date display • Tritnite® luminous hands
- Band:** High grade polyurethane band in black color with stainless steel buckle with etched logo
- Water resistant:** 100 meters



Model 6840



Model 6841



Model 6842

INVICTA

S1 SPORT CHRONO

Movement: Professional Swiss made GMT quartz

Case and dial: ø 52 mm • Solid stainless steel case with screws on top • Stainless steel screw down case back • Flame fusion crystal • Enamel dial in assorted colors with transparent plastic plate
• Stainless steel crown with etched logo • Date display • Tritnite® luminous hands

Band: High grade polyurethane hand in black color with stainless steel buckle with etched logo

Water resistant: 100 meters



Model 6843



Model 6844



Model 6846



Model 6847



Model 6845



Model 6848

INVICTA

S1 SPORT CHRONO

Movement: Professional Swiss made GMT quartz

Case and dial: ø 52mm • Solid stainless steel case with screws on top • Stainless steel screw down case back • Flame fusion crystal • Enamel dial in assorted colors with transparent plastic plate • Stainless steel crown with etched logo • Date display • Tritnite® luminous hands

Band: High grade polyurethane hand in black color with stainless steel buckle with etched logo

Water resistant: 100 meters



Covert operations are revealed as Invicta's stealth Coalition Forces Collection steps into the fore. Conditioned to handle the most sophisticated of endeavors, the Coalition Forces are at the ready, available for the day-to-day maneuvers to come. Strategically prepared for all operatives, this technically deft collection is crafted with Swiss movements and emboldened with the attributes of true leadership. Invicta's Coalition Forces Collection reaches the front line with the command, range and tactics for decisive action, turning time into a multi-faceted vision quest.



INVICTA

COALITION FORCES

Movement: Professional Swiss made with EL Back Light movement with digital compass

Case and dial: ø 51mm • Solid stainless steel case in titanium sandblast • Stainless steel screw down case back • Unidirectional turning bezel with aluminium plate • Flame fusion crystal

- Black enamel dial with big hollow • Stainless steel screw down crown with protective cap
- Stainless steel pusher and screw down pushers • Tritnite® luminous hands • Ionic gun metal plating
- Black ionic plating • Extra 2 sets stainless steel screw pins for interchangeable device

Band: Solid stainless steel band in titanium sandblast • Stainless steel diver buckle with safety lock

Extra band for interchangeable: High grade polyurethane Band in grey color with metal insert

- Stainless steel buckle • Black ionic plating

Water resistant: 100 meters



Model 6423

INVICTA

COALITION FORCES GMT

Movement: Professional Swiss made GMT quartz movement

Case and dial: ø 51mm • Solid titanium sandblast case • Stainless steel screw down case back

- Unidirectional turning bezel with aluminium plate • Flame fusion crystal

- Black enamel dial with turnable inner ring • Stainless steel screw down crown with protective cap
- Stainless steel pushers • Date display • Tritnite® luminous hands • Ionic gun metal plating
- Black ionic plating • Extra 2 sets stainless steel screw pins for interchangeable device

Band: Solid titanium sandblast band • Stainless steel diver buckle with safety lock

Extra band for interchangeable: High grade polyurethane Band in grey color with metal insert

- Stainless steel buckle • Black ionic plating

Water resistant: 100 meters



Model 6494

INVICTA

COALITION FORCES CHRONO

Movement: Professional Swiss made quartz chronograph • 13 jewels

Case and dial: ø 50 mm • Solid titanium sandblast case • Unidirectional turning bezel

• Stainless steel screw down case back in titanium colors • Flame fusion crystal

• Matte dial in assorted colors with rotating inner ring • Stainless steel screw down crown and pushers

• Stainless steel screw down crown for rotating inner ring • Date display • Tritnite® luminous hands

• Black ionic plating

Band: High grade polyurethane strap in assorted colors with titanium insets

• Stainless steel buckle in titanium color

Water resistant: 100 meters



Model 0229



Model 0230



Model 0231



Model 0232

INVICTA

COALITION FORCES CHRONO

Movement: Professional Swiss made quartz chronograph • 13 jewels

Case and dial: ø 50 mm • Solid titanium sandblast case • Unidirectional turning bezel

• Stainless steel screw down case back in titanium colors • Flame fusion crystal

• Matte dial in assorted colors with rotating inner ring • Stainless steel screw down crown and pushers

• Stainless steel screw down crown for rotating inner ring • Date display • Tritnite® luminous hands

• Black ionic plating

Band: High grade polyurethane strap in assorted colors with titanium insets

• Stainless steel buckle in titanium color

Water resistant: 100 meters

INVICTA

COALITION FORCES GMT

Movement: Professional Swiss made quartz GMT

Case and dial: ø 50 mm • Solid titanium sandblast case in titanium color • Flame fusion crystal

- Matte dial in assorted colors with rotating inner ring • Stainless steel screw down crown
- Stainless steel screw down crown for rotating inner ring • Date display • Tritnite® luminous hands
- Black ionic plating

Band: High grade polyurethane strap in assorted colors with titanium insets

- Stainless steel buckle in titanium color

Water resistant: 100 meters



Model 0224



Model 0225

INVICTA

COALITION FORCES GMT

Movement: Professional Swiss made quartz GMT

Case and dial: ø 50 mm • Solid titanium sandblast case in titanium color • Flame fusion crystal

- Matte dial in assorted colors with rotating inner ring • Stainless steel screw down crown
- Stainless steel screw down crown for rotating inner ring • Date display • Tritnite® luminous hands
- Black ionic plating

Band: High grade polyurethane strap in assorted colors with titanium insets

- Stainless steel buckle in titanium color

Water resistant: 100 meters



Model 0226



Model 0227



Model 0228

INVICTA



A place in time.

Invicta's Corduba will guide you through the hours and days with absolute ease and style. Taking inspiration from classic military looks while catering to ladies and gents alike, the ever-growing collection of Corduba timepieces offer such features as large dials, exhibition case backs, day and date displays, 200 meter water resistance, and special crown protection caps. Slip in and out of time knowing Invicta's Corduba will be following your moments even when you're not.



INVICTA

CORDUBA INTERCEPTOR CHRONO

Movement: Professional Swiss quartz chronograph

Case and dial: ø 52 mm • Surgical grade solid stainless steel case with unidirectional rotating bezel

- 18kt ionic gold plating • Flame fusion crystal • Stianless steel screw down case back
- Stainless steel crown with protector • Stainless steel pushers
- Textured dial in assorted colors • Tritnite® luminous indexes and hands • Date display

Band: High gradeolyurethane strap with metal parts • 18kt ionic gold plating

Water resistant: 200 meters



Model 6917



Model 6915



Model 6916

INVICTA

CORDUBA INTERCEPTOR CHRONO

Movement: Professional Swiss quartz chronograph

Case and dial: ø 52 mm • Surgical grade solid stainless steel case with unidirectional rotating bezel

- Flame fusion crystal • Stianless steel screw down case back • Stainless steel crown with protector
- Stainless steel pushers
- Textured dial in assorted colors • Tritnite® luminous indexes and hands • Date display

Band: High grade olyurethane strap with metal parts

Water resistant: 200 meters



Model 6913



Model 6914

INVICTA

CORDUBA CHRONO SPORT

Movement: Professional quartz chronograph

Case and dial: ø 52 mm • Surgical grade solid stainless steel case • Unidirectional rotating bezel

- Solid stainless steel closed case back • Screw down security crown with protective cap
- Moulded Corduba logo on the end pieces • Genuine mother of pearl dial with Tritnite® luminous hands and indexes • Date display • 18kt gold plating

Band: Surgical grade textured solid stainless steel and black polyurethane band with dual deployment buckle

Water resistant: 200 meters



Model 0478
MOP

INVICTA

CORDUBA CHRONO SPORT

Movement: Professional quartz chronograph

Case and dial: ø 52 mm • Surgical grade solid stainless steel case • Unidirectional rotating bezel

- Solid stainless steel closed case back • Screw down security crown with protective cap
- Moulded Corduba logo on the end pieces
- Genuine mother of pearl dial with Tritnite® luminous hands and indexes • Date display

Band: Surgical grade textured solid stainless steel and black polyurethane band with dual deployment buckle

Water resistant: 200 meters



Model 0477
MOP



Model 0476
MOP

INVICTA

CORDUBA SWISS CHRONO

Movement: Professional quartz chronograph

Case and dial: ø 52 mm • Surgical grade solid stainless steel case • Unidirectional rotating bezel
 • 18kt gold plating • Solid stainless steel case back • Screw down security crown with protective cap •
 Sunray dials in assorted colors • Tritnite® luminous hands & Indexes • Date display

Band: Surgical grade textured solid stainless steel and colored polyurethane band
 with dual deployment buckle • 18kt gold plating

Water resistant: 200 meters



Model 6676



Model 6677

INVICTA

CORDUBA SWISS CHRONO

Movement: Professional quartz chronograph

Case and dial: ø 52 mm • Surgical grade solid stainless steel case • Unidirectional rotating bezel
 • Solid stainless steel case back • Screw down security crown with protective cap
 • Sunray dials in assorted colors • Tritnite® luminous hands & Indexes • Date display

Band: Surgical grade textured solid stainless steel and colored polyurethane band
 with dual deployment buckle

Water resistant: 200 meters



Model 6674



Model 6675

INVICTA PRO DIVER

MASTER OF THE OCEANS

Plunge into any horizon using the steadfast guidance of the Invicta Pro Diver. Stylishly classic, internal workings are forged with variations of either Swiss chronograph or 21-jewel automatic movements and willingly navigate in depths up to 300 meters. Built with confident prowess, the fortitude with which these timepieces function makes the Pro Diver the quintessential in performance.



INVICTA

PRO DIVER ELEMENTAL

Movement: Professional quartz chronograph

Case and dial: ø 47 mm • Surgical grade solid stainless steel in combination brush and shiny finish

- Unidirectional turning bezel • Stainless steel screw down case back • Triple screw down crown
- Helmet logo etched on the crown • Flame fusion crystal • Red Cedar and Vera wood dials
- Tritnite® luminous indexes and hands • Date display

Band: Surgical grade solid stainless steel band with center link in Red Cedar and Vera Wood with Diver buckle and safety clasp • Helmet logo molded on the solid end pieces of the band

Water resistant: 200 meters

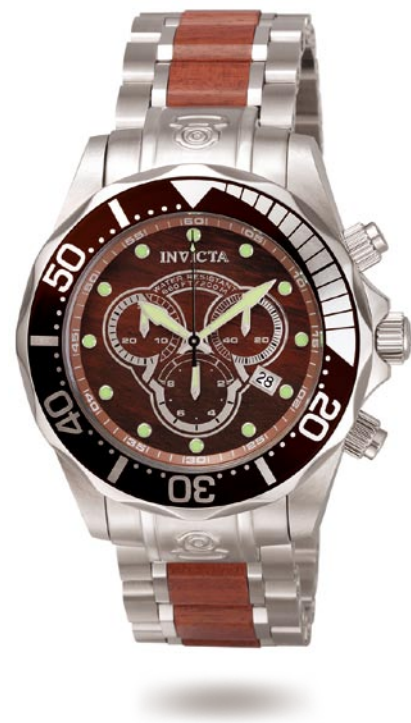

Model 0164
Red Cedar Wood



Model 0165
Vera Wood

INVICTA

PRO DIVER ELEMENTAL

Movement: Professional quartz chronograph

Case and dial: ø 47 mm • Surgical grade solid stainless steel in combination brush and shiny finish

- Unidirectional turning bezel • Stainless steel screw down case back • Triple screw down crown
- Helmet logo etched on the crown • Flame fusion crystal • Dials made real wood in dark grey color
- Tritnite® luminous indexes and hands • Date display

Band: Surgical grade solid stainless steel band with center link in real wood with diver buckle and safety clasp • Helmet logo molded on the solid end pieces of the band

Water resistant: 200 meters



Model 0858
Ebony Wood

INVICTA

PRO DIVER II CHRONO

Movement: Professional quartz

Case and dial: ø 49.5 mm • Solid stainless steel case • Unidirectional rotating bezel

• Stainless steel screw down case back • Flame fusion crystal

• Stainless steel screw down crown and pushers • Textured dial in assorted colors with applied rings

• Date display • Tritnite® luminous hands • Black ionic plating

Band: Solid stainless steel band with stainless steel diver buckle with safety lock • Black ionic plating

Water resistant: 100 meters



Model 0500



Model 0499



INVICTA
PRO DIVER

MASTER OF THE OCEANS

INVICTA

PRO DIVER II QUARTZ

Movement: Professional quartz

- Case and dial: ø 49.5 mm • Solid stainless steel case • Stainless down screw down case back
 • Unidirectional turning bezel • Flame fusion crystal • Stainless steel screw down crown with logo
 • Sunray and textured dial in assorted colors • Date display • Tritnite® luminous hands
 • Black ionic plating

Band: Solid stainless steel band with Diver buckle and safety lock • Black ionic plating

Water resistant: 100 meters



Model 0504



Model 0501

INVICTA

PRO DIVER II QUARTZ

Movement: Professional quartz

- Case and dial: ø 49.5 mm • Solid stainless steel case • Stainless down screw down case back
 • Unidirectional turning bezel • Flame fusion crystal • Stainless steel screw down crown with logo
 • Sunray and textured dial in assorted colors • Date display • Tritnite® luminous hands

Band: Solid stainless steel band with Diver buckle and safety lock

Water resistant: 100 meters



Model 0503



Model 0502



Model 0505

INVICTA
OCEAN GHOST AUTOMATIC

Movement: 21 jewel automatic • Shock resistant
Case and dial: ø 47 mm • Solid stainless steel case with skeleton exhibition case back • 18kt gold plating
• Flame fusion crystal with magnifier • Invicta accent cabochon design
• Tritnite® luminous hands and markers • Date display
Band: Solid stainless steel • 18kt gold plating
Water resistant: 200 meters



Model 2303



Model 2305



Model 2304



Model 2306



Case Back

INVICTA
OCEAN GHOST AUTOMATIC

Movement: 21 jewel automatic • Shock resistant
Case and dial: ø 47 mm • Solid stainless steel case with skeleton exhibition case back • 18kt gold plating
• Flame fusion crystal with magnifier • Invicta accent cabochon design
• Tritnite® luminous hands and markers • Date display
Band: Solid stainless steel • 18kt gold plating
Water resistant: 200 meters



Model 2307



Model 2308



Model 2309



Case Back

INVICTA

OCEAN GHOST AUTOMATIC

Movement: 21 jewel automatic • Shock resistant
 Case and dial: ø 47 mm • Solid stainless steel case with skeleton exhibition case back
 • Flame fusion crystal with magnifier • Invicta accent cabochon design
 • Tritnite® luminous hands and markers • Date display
 Band: Solid stainless steel Water resistant: 200 meters



Model 2300



Model 2301



Model 2302



Case Back



INVICTA
 PRO DIVER

MASTER OF THE OCEANS

INVICTA

PRO DIVER SCUBA CHRONOGRAPH

Movement: Professional chronograph

Case and dial: ø 48 mm • Surgical grade solid stainless steel case and rotating bezel

- Screw down stainless steel case back • Flame fusion crystal • Sunray dial with luminous markers
- Tritnite® luminous hands • Date display • 18kt gold plating

Band: Surgical grade solid stainless steel with solid stainless steel safety diver buckle • 18kt gold plating

Water resistant: 200 meters



Model 0072

Model 0073

Model 0074



Model 0075



Model 0077

INVICTA

PRO DIVER SCUBA CHRONOGRAPH

Movement: Professional chronograph

Case and dial: ø 48 mm • Surgical grade solid stainless steel case and rotating bezel

- Screw down stainless steel case back • Flame fusion crystal • Sunray dial with luminous markers
- Tritnite® luminous hands • Date display

Band: Surgical grade solid stainless steel with solid stainless steel safety diver buckle

Water resistant: 200 meters



Model 0069

Model 0070

Model 0071

INVICTA

PRO DIVER SCUBA GMT

Movement: Professional Swiss quartz • 9 jewels • Power reserver • GMT & alarm

Case and dial: ø 48.8 mm • Solid stainless steel case • Unidirectional bezel

• Screw down stainless steel case back • Flame fusion crystal • 9H case side with etched logo

• Sunray dial in assorted colors • Date display • Tritnite® luminous hands

Band: Solid stainless steel band with stainless steel diver buckle and safety lock

Water resistant: 100 meters



Model 6086



Model 6087



Model 6088



Model 6089



Model 6090



Model 6091

INVICTA

PRO DIVER SCUBA GMT

Movement: Professional Swiss GMT quartz • 9 jewels

Case and dial: ø 48.8 mm • Solid stainless steel case • Unidirectional turning bezel

• Screw down stainless steel case back • Flame fusion crystal • 9H case side with etched logo

• Sunray dial in assorted colors • Date display • Tritnite® luminous hands

Band: Solid stainless steel band with stainless steel diver buckle and safety lock

Water resistant: 100 meters

INVICTA

PRO DIVER SCUBA CHRONO

Movement: Professional Swiss chronograph • 6 jewels

Case and dial: ø 48.8 mm • Solid stainless steel case • Unidirectional aluminum bezel in assorted colors

- Stainless steel screw down case back • Stainless steel screw down crown and pushers
- Flame fusion crystal • Sunray polished dial in assorted colors with dome shape indexes • Date display
- Tritnite® luminous hands and indexes • 18kt gold plating

Band: High grade polyurethane strap with stainless steel metal links • Stainless steel buckle with logo

- 18kt gold plating • Black ionic plating

Water resistant: 100 meters



Model 6981



Model 6982



Model 6983

INVICTA

PRO DIVER SCUBA CHRONO

Movement: Professional Swiss chronograph • 6 jewels

Case and dial: ø 48.8 mm • Solid stainless steel case • Unidirectional aluminum bezel in assorted colors

- Stainless steel screw down case back • Stainless steel screw down crown and pushers
- Flame fusion crystal • Sunray polished dial in assorted colors with dome shape indexes • Date display
- Tritnite® luminous hands and indexes • 18kt gold plating

Band: High grade polyurethane strap with stainless steel metal links • Stainless steel buckle with logo

- 18kt gold plating

Water resistant: 100 meters



Model 6984



Model 6985

INVICTA

PRO DIVER SCUBA CHRONO

Movement: Professional Swiss chronograph movement • 6 jewels

Case and dial: ø 48.8 mm • Solid stainless steel case • Unidirectional aluminum bezel

• Stainless steel screw down case back • Stainless steel screw down crown and pushers

• Flame fusion crystal • Sunray polished dial in assorted colors with dome shape indexes • Date display

• Tritnite® luminous hands and indexes • Black ionic plating

Band: High grade polyurethane strap with stainless steel metal links • Stainless steel buckle with logo

• Black ionic plating

Water resistant: 100 meters



Model 6986



Model 6977

INVICTA

PRO DIVER SCUBA GMT

Movement: Professional Swiss chronograph movement • 6 jewels

Case and dial: ø 48.8 mm • Solid stainless steel case • Unidirectional aluminum bezel

• Stainless steel screw down case back • Stainless steel screw down crown and pushers

• Flame fusion crystal • Sunray polished dial in assorted colors with dome shape indexes • Date display

• Tritnite® luminous hands and indexes

Band: High grade polyurethane strap with stainless steel metal links • Stainless steel buckle with logo

Water resistant: 100 meters



Model 6978



Model 6979



Model 6980

INVICTA

PRO DIVER SCUBA GMT

Movement: Professional Swiss GMT

Case and dial: ø 48•8 mm • Solid stainless steel case • Unidirectional aluminum bezel in assorted colors
 • Stainless steel screw down case back • Stainless steel screw down crown
 • Flame fusion crystal with magnifier • Sunray polished dial in assorted colors with dome shape indexes
 • Date display • Tritnite® luminous hands and indexes • 18kt gold plating
 Band: High grade polyurethane strap with stainless steel metal links • Stainless steel buckles with logo
 • 18kt gold plating

Water resistant: 100 meters



Model 6991



Model 6992



Model 6993

INVICTA

PRO DIVER SCUBA GMT

Movement: Professional Swiss GMT

Case and dial: ø 48•8 mm • Solid stainless steel case • Unidirectional aluminum bezel
 in assorted colors • Stainless steel screw down case back • Stainless steel screw down crown
 • Flame fusion crystal with magnifier • Sunray polished dial in assorted colors with dome shape indexes
 • Date display • Tritnite® luminous hands and indexes • 18kt gold plating
 Band: High grade polyurethane strap with stainless steel metal links • Stainless steel buckles with logo
 • 18kt gold plating

Water resistant: 100 meters



Model 6994



Model 6995

INVICTA

PRO DIVER SCUBA GMT

Movement: Professional Swiss GMT

Case and dial: ø 48•8 mm • Solid stainless steel case • Unidirectional aluminum bezel

- Stainless steel screw down case back • Stainless steel screw down crown
- Flame fusion crystal with magnifier • Sunray polished dial with dome shape indexes • Date display
- Tritnite® luminous hands and indexes • Black ionic plating

Band: High grade polyurethane strap with stainless steel metal links • Stainless steel buckles with logo

• Black ionic plating

Water resistant: 100 meters



Model 6996



Model 6987

INVICTA

PRO DIVER SCUBA GMT

Movement: Professional Swiss GMT

Case and dial: ø 48•8 mm • Solid stainless steel case • Unidirectional aluminum bezel

- Stainless steel screw down case back • Stainless steel screw down crown
- Flame fusion crystal with magnifier • Sunray polished dial in assorted colors with dome shape indexes
- Date display • Tritnite® luminous hands and indexes

Band: High grade polyurethane strap in assorted colors with stainless steel metal links

• Stainless steel buckles with logo

Water resistant: 100 meters



Model 6988



Model 6989



Model 6990

INVICTA

GRAND DIVER PRO AUTOMATIC

Movement: 21 jewel automatic • Shock resistant

Case and dial: ø 47 mm • Surgical grade solid stainless steel • Unidirectional bezel • 18kt gold plating
• Screw down stainless steel skeleton exhibition case back • Etched helmet logo on screw down crown
• Flame fusion crystal with magnifier • Sunray dial • Tritnite® luminous hands and markers • Date display

Band: Surgical grade solid stainless steel with diver buckle and safety clasp
• Helmet logo molded on the solid end pieces of the band • 18kt gold plating

Water resistant: 300 meters



Model 3051



Model 3052



Model 3049



Model 3050



Case Back

INVICTA

GRAND DIVER PRO AUTOMATIC

Movement: 21 jewel automatic • Shock resistant

Case and dial: ø 47 mm • Surgical grade solid stainless steel • Unidirectional bezel
• Screw down stainless steel skeleton exhibition case back • Etched Helmet logo on screw down crown
• Flame fusion crystal with magnifier • Sunray dial • Tritnite® luminous hands and markers • Date display

Band: Surgical grade solid stainless steel with diver buckle and safety clasp
• Helmet logo molded on the solid end pieces of the band

Water resistant: 300 meters



Model 3044



Model 3045



Model 3046



Case Back

INVICTA

PRO DIVER SPORT AUTOMATIC

Movement: Professional automatic

- Case and dial: ø 43 mm • Solid stainless steel in combination brush and shiny finish
- Unidirectional turning bezel • Flame fusion crystal • Stainless steel screw down exhibition case back
 - Stainless steel screw down crown • Sunray dials / white super luminova dial • White super luminova indexes and hands • White super luminova glows light blue in darkness • Date display

Band: Stainless steel band with divers buckle and safety clasp

Water resistant: 200 meters



Model 0997



Model 0998



Model 0999



Model 1000



Model 1001



Model 1002

INVICTA

PRO DIVER SPORT CHRONO

Movement: Professional quartz chronograph

- Case and dial: ø 43 mm • Solid stainless steel in combination brush and shiny finish
- Unidirectional turning bezel • Flame fusion crystal • Stainless steel screw down case back
 - Stainless steel screw down crown and pushers • Sunray dials / white super luminova dial • White super luminova indexes and hands • White super luminova glows light blue in darkness • Date display

Band: Stainless Steel Band with Divers Buckle and Safety Clasp

Water resistant: 200 meters



Model 1003



Model 1004



Model 1005



Model 1006



Model 1007

INVICTA
SWISS AUTOMATIC PRO DIVER

Movement: 25 jewel automatic • Shock resistant
Case and dial: ø 42 mm • Solid stainless steel • Unidirectional bezel
• 18kt gold plating • Screw down crown • Screw down stainless steel exhibition case back
• Flame fusion crystal with magnifier • Sunray dial • Tritnite® luminous hands and markers • Date display
Band: Solid stainless steel buckle with safety clasp • 18kt gold plating
Water resistant: 200 meters



Model 9938



Model 9937



9938
Case Back



9937
Case Back

INVICTA
PRO DIVER AUTOMATIC

Movement: 21 jewel automatic • Shock resistant
Case and dial: ø 43 mm • Solid stainless steel • Unidirectional bezel • 18kt gold plating
• 18kt rose gold plating • Screw down stainless steel skeleton exhibition case back
• Flame fusion crystal with magnifier • Tritnite® luminous hands and markers • Date display
Band: Solid stainless steel diver buckle with safety clasp • 18kt gold plating • 18kt rose gold plating
Water resistant: 200 meters



Model 9010



Model 9423



Case Back

INVICTA

PRO DIVER AUTOMATIC

Movement: 21 jewel automatic • Shock resistant
 Case and dial: ø 43 mm • Solid stainless steel • Unidirectional bezel • 18kt gold plating
 • Screw down stainless steel skeleton exhibition case back • Flame fusion crystal with magnifier
 • Tritnite® luminous hands and markers • Date display
 Band: Solid stainless steel diver buckle with safety clasp • 18kt gold plating
 Water resistant: 200 meters



Model 8929

Model 8930

Model 9743



Model 8927

Model 8928

Case Back

INVICTA

PRO DIVER AUTOMATIC

Movement: 21 jewel automatic • Shock resistant
 Case and dial: ø 43 mm • Solid stainless steel • Unidirectional bezel
 • Screw down stainless steel skeleton exhibition case back • Flame fusion crystal with magnifier
 • Tritnite® luminous hands and markers • Date display
 Band: Solid stainless steel diver buckle with safety clasp
 Water resistant: 200 meters



Model 5053

Model 8926

Model 9094



Model 9403

Model 9404

Model 9110

INVICTA

MENS TITANIUM PRO DIVER

Movement: Professional automatic

Case and dial: ø 44 mm • All titanium case with unidirectional bezel

• Titanium screw down exhibition case back • Screw down crown with logo

• Black dial with Tritnite® luminous hands and indexes • Date display

Band: All titanium band with titanium diver buckle and safety clasp

Water resistant: 200 meters



Model 0420



Case Back

INVICTA

SWISS PRO DIVER QUARTZ

Movement: Swiss quartz • Shock resistant

Case and dial: ø 43 mm for male / ø 34 mm for female • Solid stainless steel • Unidirectional bezel

• Screw down stainless steel case back • Screw down security crown • Flame fusion crystal with magnifier •

Tritnite® luminous hands and markers • Date display

Band: Solid stainless steel diver buckle with safety clasp

Water resistant: 200 meters



Model 9308



Model 9307



Model 4863



Model 4862

INVICTA
SWISS PRO DIVER QUARTZ

Movement: Swiss quartz • Shock resistant
Case and dial: ø 43 mm for male / ø 34 mm for female • Solid stainless steel • Unidirectional bezel
• 18kt gold plating • Screw down stainless steel case back • Screw down security crown
• Flame fusion crystal with magnifier • Tritnite® luminous hands and markers • Date display
Band: Solid stainless steel diver buckle with safety clasp • 18kt gold plating
Water resistant: 200 meters



Model 9312



Model 9311



Model 2155



Model 4870



Model 4869



Model 4871

INVICTA
SWISS PRO DIVER QUARTZ

Movement: Swiss quartz • Shock resistant
Case and dial: ø 43 mm for male / ø 34 mm for female • Solid stainless steel • Unidirectional bezel
• 18kt gold plating • Screw down stainless steel case back • Screw down security crown
• Flame fusion crystal with magnifier • Tritnite® luminous hands and markers • Date display
Band: Solid stainless steel diver buckle with safety clasp • 18kt gold plating
Water resistant: 200 meters

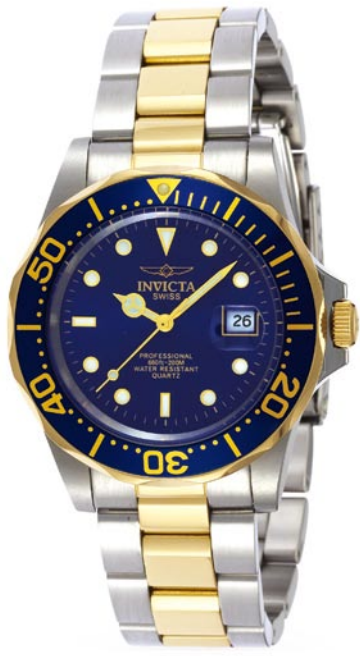

Model 9310



Model 9309



Model 4868



Model 4867

INVICTA

PRO DIVER QUARTZ

Movement: Professional quartz • Shock resistant

Case and dial: ø 39 mm for male / ø 23 mm and ø24•5 mm(model 4610) for female • Solid stainless steel
 • Unidirectional bezel • 18kt gold plating • Screw down stainless steel case back • Screw down security crown
 • Flame fusion crystal with magnifier • Tritnite® luminous hands and markers • Date display

Band: Solid stainless steel diver buckle with safety clasp • 18kt gold plating

Water resistant: 200 meters



Model 8938



Model 8937



Model 8936



Model 4610



Model 8945



Model 8944



Model 8943

INVICTA

PRO DIVER QUARTZ

Movement: Professional quartz • Shock resistant

Case and dial: ø 39 mm for male / ø 23 mm for female • Solid stainless steel • Unidirectional bezel
 • 18kt gold plating • Screw down stainless steel case back • Screw down security crown
 • Flame fusion crystal with magnifier • Tritnite® luminous hands and markers • Date display

Band: Solid stainless steel diver buckle with safety clasp • 18kt gold plating

Water resistant: 200 meters



Model 8935



Model 8934



Model 8942



Model 8941

INVICTA

PRO DIVER QUARTZ

Movement: Professional quartz • Shock resistant

Case and dial: ø 39 mm for male / ø 23 mm for female • Solid stainless steel

- Unidirectional bezel • Screw down stainless steel case back • Screw down security crown
- Flame fusion crystal with magnifier • Tritnite® luminous hands and markers • Date display

Band: Solid stainless steel diver buckle with safety clasp

Water resistant: 200 meters



Model 9204



Model 8933



Model 8932



Model 9177



Model 8940



Model 8939

INVICTA

PRO DIVER SPORT

Movement: Professional quartz

Case and dial: ø 44 mm • Stainless steel case with unidirectional bezel • Flame fusion crystal

- Stainless steel screw down case back • Genuine mother of pearl dial
- Tritnite® luminous hands and indexes • Date display • 18kt gold plating

Band: High grade black polyurethane strap with metal inserts • 18kt gold plating

Water resistant: 100 meters



Model 0996
MOP



Model 0492
MOP

INVICTA

SPORT DIVER AUTOMATIC

Movement: Professional automatic

Case and dial: ø 44 mm • Stainless steel case with unidirectional bezel • Flame fusion crystal

- Stainless steel screw down exhibition case back • Genuine mother of pearl dial
- Tritnite® luminous hand and index • Date display

Band: High grade polyurethane strap

Water resistant: 100 meters



Model 0467
MOP

Model 0468
MOP

Model 0469
MOP

INVICTA

SPORT DIVER AUTOMATIC

Movement: Professional automatic

Case and dial: ø 38 mm • Stainless steel case with unidirectional bezel • Flame fusion crystal

- Stainless steel screw down exhibition case back • Genuine mother of pearl dial
- Tritnite® luminous hand and index • Date display

Band: High grade polyurethane strap

Water resistant: 100 meters



Model 0490
MOP

Model 0491
MOP



Case Back

INVICTA

S P E E D W A Y
COLLECTION

G A I N E D M O M E N T U M

Conveying time with the utmost sophistication while keeping in mind the needs of the active sportsman, the Invicta Speedway collection will effortlessly transpose into any journey. Swiss Chronograph movement, 200 meter water resistance, screw down case backs, Tritnite® luminous hands, textured dials in multiple colors are all features inclusive in these handsomely crafted timepieces.

An asset to any activity, allow the Speedway to merge into your sporting and working life.



INVICTA

SPEEDWAY CHRONOGRAPH

- Movement:** Professional quartz chronograph
- Case and dials:** ø 44 mm • Solid stainless steel case • 18kt gold plating
- Triple screw down security crown and pushers • Screw down stainless steel case back
 - Flame fusion crystal • Tritnite® luminous hands and markers
- Band:** Solid stainless steel with deployment buckle • 18kt gold plating
- Water resistant:** 200 meters



Model 9224



Model 9212



Model 3644



Model 9554



Model 9329

INVICTA

SPEEDWAY CHRONOGRAPH

- Movement:** Professional quartz chronograph
- Case and dials:** ø 44mm • Solid stainless steel case • Triple screw down security crown and pushers
- Screw down stainless steel case back • Flame fusion crystal • Tritnite® luminous hands and markers
- Band:** Solid stainless steel with deployment buckle
- Water resistant:** 200 meters

INVICTA

SPEEDWAY CHRONOGRAPH

Movement: Professional quartz chronograph

Case and dials: ø 44mm • Solid stainless steel case • Triple screw down security crown and pushers
• Screw down stainless steel case back • Flame fusion crystal • Tritnite® luminous hands and markers

Band: Solid stainless steel with deployment buckle

Water resistant: 200 meters



Model 9223



Model 9211

INVICTA

SPEEDWAY CLASSIC CHRONO

Movement: Professional quartz chronograph

Case and dials: ø 40mm • Solid stainless steel in combination brush and shiny finish with fixed top ring
• 18kt rose gold plating • Black ionic plating • Flame fusion crystal • Stainless steel screw down case back

• Screw down crown and pushers • Textured dials • Tritnite® luminous index and hand • Date display

Band: Solid stainless steel with diver buckle and safety lock • 18kt rose gold plating

• Black ionic plating

Water resistant: 200 meters



Model 6933



Model 6932



Model 6934



A revolutionary constitution by a democratic leading Force. Focused on an end to class antagonisms, the Invicta Force collection brings about change, and makes what was once in reach of only a few elite, now affordable to all. Commanded by automatic or professional quartz chronograph movements housed within surgical grade solid stainless steel cases, leather straps, Tritnite® luminous hands, and submergible to 100 meters, the Invicta Force is prepared for war and ready for peace.



INVICTA
LEFTY CHRONOGRAPH

Movement: Professional quartz chronograph

Case and dial: ø 46 mm • Solid stainless steel • Solid stainless steel screw down case back
• Flame fusion crystal • Matte dial • Crown and pushers at 9 o'clock position
• Tritnite® luminous hands • Date display

Band: Genuine leather strap with stainless steel buckle
Water resistant: 100 meters



Model 2770



Model 2771



Model 2772

INVICTA
LEFTY CHRONOGRAPH

Movement: Professional quartz chronograph

Case and dial: ø 46 mm • Solid stainless steel case • 18kt gold plating • Black ionic plating
• Screw down case back • Flame fusion crystal • Matte dial • Crown and pushers at 9 o'clock position
• Tritnite® luminous hands • Date display

Band: Genuine bull strap with stainless steel buckle • 18kt gold plating • Black ionic plating
Water resistant: 100 meters



Model 3329



Model 3330



Model 3332



Model 3328

INVICTA

FORCE MASTER MILITARY QUARTZ

Movement: Professional quartz multifunction

Case and dial: ø 48 mm • Solid stainless steel case with fixed top ring • Flame fusion crystal

• Stainless steel screw down case back • Stainless steel crown with logo on it • Sunray dial

• Tritnite® luminous hands • Day and date display

Band: Genuine calf leather

Water resistant: 100 meters



Model 0764



Model 0765



INVICTA
I
FORCE
TO BE
RECKONED
WITH

INVICTA

TERRA RETRO MILITARY

Movement: Professional quartz multifunction movement

Case and dial: ø 45 mm • Solid stainless steel case in combination brush and shiny finish

- Stainless steel screw down case back • Flame fusion crystal • Stainless steel crown with logo on it
- Matte / Sunray dials with Tritnite® luminous hands and indexes • Month, day, date and dual time display

Band: Genuine Calf leather

Water resistant: 100 meters



Model 0350

Model 0351

Model 0352

INVICTA

TERRA RETRO MILITARY

Movement: Professional quartz multifunction movement

Case and dial: ø 45 mm • Solid stainless steel case in combination brush and shiny finish

- Ionic gun plating • Stainless steel screw down case back • Flame fusion crystal
- Stainless steel crown with logo on it • Matte / Sunray dials with Tritnite® luminous hands and indexes
- Month, day, date and dual time display

Band: Genuine Calf leather

Water resistant: 100 meters



Model 0353

Model 0354

Model 0355

INVICTA

TERRA RETRO FLEX

Movement: Professional swiss quartz

Case and dial: ø 48.5 mm • Solid stainless steel case with titanium color fixed bezel

- Stainless steel screw down case back • Flame fusion crystal • Stainless steel screw down crown with logo
- Textured dial in assorted colors • Date display • Tritnite® luminous hands

Band: High grade polyurethane strap in black color with stainless steel metal links

- Stainless steel buckle with logo

Water resistant: 100 meters



Model 0322



Model 0321



Model 0324



Model 0323



INVICTA
I
FORCE
TO BE
RECKONED
WITH



INVICTA VINTAGE

COLLECTION

Keeping Swiss Time Since 1837.

Reaching back through time, Invicta's Vintage collection captures the stylish elegance of the past and places it firmly on the wrist of the present. The result of this synthesis includes the original Invicta IV logo dating from 1837, exhibition case backs, antique finished dials, Roman numerals, alarm functions, leather straps or stainless steel bracelets. Evocative of classic European watch making yet striking the perfect balance between the past and future, the very best of the old and new world meet here at the point of Vintage.



INVICTA

VINTAGE CLASSIC STEEL

Movement: Professional Swiss made chronograph with big date

Case and dial: ø 47mm • Surgical grade solid stainless steel • Flame fusion crystal

- Stainless steel screw down case back • Stainless steel crown and pushers with Invicta Vintage logo etched on the crown • Sunray or carbon fiber dials • Tritnite® luminous hands • Big date display

Band: Surgical grade stainless steel band with push button deployment buckle

Water resistant: 50 meters



Model 0417



Model 0418



Model 0419



INVICTA

VINTAGE

COLLECTION

Keeping Swiss Time Since 1837.

INVICTA

VINTAGE CLASSIC

Movement: Professional quartz movement

Case and dial: ø 44 mm • Solid stainless steel case • Flame fusion crystal • 18kt ionic gold plating
• 18kt rose gold plating • Stainless steel screw down case back • Stainless steel crown with logo on it
• Sunray dial • Tritnite® luminous hands • Day and date display

Band: Genuine leather

Water resistant: 50 meters



Model 6750



Model 6751



Model 6753



Model 6752

INVICTA

VINTAGE CLASSIC

Movement: Professional quartz movement

Case and dial: ø 44 mm • Solid stainless steel case • Flame fusion crystal
• Stainless steel screw down case back • Stainless steel crown with logo on it • Sunray dial
• Tritnite® luminous hands • Day and date display

Band: Genuine leather

Water resistant: 50 meters



Model 6749

INVICTA
LUPAH
THE LAST WORD
ON BOLD MOVEMENTS

Invicta's Lupah continues to brazenly hit the streets defying the myth of urban trends. Always offering the original signature stylings for which the patented Lupah is known, Invicta has also diversified the line to encompass a varied range of choices and models. While Swiss movements keep this watch in motion, the collection is further accented by a wide selection of colorful straps and dial treatments. It's distinctive look and smarts will keep Lupah in tune with any mood of any moment in any time.



INVICTA

LUPAH REVOLUTION AUTOMATIC

Movement: Professional Swiss made SW500 automatic movement • 25 jewels • Shock resistant 28,000vph

Case and dial: ø 46.8 mm • Solid stainless steel case • Stainless steel exhibition case back with screws

- Flame fusion crystal • Sunray and genuine mother of pearl dial with 3D applied Arabic & markers with white diamonds • Date display • Tritnite® luminous hands • Ionic gun metal plating

Band: Leather with tone on tone fish-bones stitching in black color

- Stainless steel buckle with etched Invicta logo • Ionic gun metal plating • 18kt rose gold plating

Water resistant: 100 meters



Model 0513



Model 0514



INVICTA
LUPAH
THE LAST WORD
ON BOLD MOVEMENTS

INVICTA

LUPAH REVOLUTION MEN'S CLASSIC

Movement: Professional Swiss made chronograph

Case and dial: ø 46.8 mm • Solid stainless steel case • Stainless steel case back with screws

- Flame fusion crystal • Sunray double layer dial with 3D applied Arabic & markers in assorted colors
- Date display • Tritnite® luminous hands • 18kt rose gold plating

Band: Leather band with tone on tone fish-bones stitching in blue and black colors

- Stainless steel buckle with etched Invicta logo • 18kt rose gold plating

Water resistant: 100 meters



Model 6734



Model 6735



Model 6736



Model 6737

INVICTA

LUPAH REVOLUTION MEN'S CLASSIC

Movement: Professional Swiss made chronograph

Case and dial: ø 46.8 mm • Solid stainless steel case • Stainless steel case back with screws

- Flame fusion crystal • Sunray double layer dial with 3D applied Arabic & markers in assorted colors
- Date display • Tritnite® luminous hands • 18kt gold plating

Band: Leather band with tone on tone fish-bones stitching in blue and black colors

- Stainless steel buckle with etched Invicta logo • 18kt gold plating

Water resistant: 100 meters



Model 6731



Model 6732

INVICTA

LADY LUPAH REVOLUTION DIAMOND

Movement: Professional Swiss made chronograph movement • 13 jewels

Case and dial: ø 36 mm • Solid stainless steel case • Stainless steel case back with screws

- Flame fusion crystal • Sunray double layer dial in assorted colors • 3D applied arabic & markers with white diamonds • Date display • Tritnite® luminous hands

Band: Croco-pattern leather band in assorted colors with tone on tone fish-bones stitching

- Stainless steel buckle with etched logo

Water resistant: 100 meters



Model 6803



Model 6822



Model 6814



Model 6811



Model 6828



Model 6815



INVICTA
LUPAH
THE LAST WORD
ON BOLD MOVEMENTS

INVICTA

LUPAH REVOLUTION

Movement: Professional Swiss made chronograph
Case and dial: ø 46.8 mm • Solid stainless steel case • Screw-on stainless steel case back
 • Flame fusion crystal • Sunray dial with 3D hand applied graphics • Date display
 • Tritnite® luminous hands
Band: Leather band with tone on tone fish-bones stitching
 • Stainless steel buckle with etched Invicta logo
Water resistant: 100 meters



Model 6097



Model 6092



Model 6127



INVICTA
LUPAH
 THE LAST WORD
 ON BOLD MOVEMENTS

INVICTA

LUPAH REVOLUTION

Movement: Professional Swiss made chronograph
Case and dial: ø 46.8 mm • Solid stainless steel case • Screw-on Stainless steel case back
 • Flame fusion crystal • Sunray dial with 3D hand applied graphics • Date display
 • Tritnite® luminous hands
Band: High grade polyurethane strap • Stainless steel buckle with etched Invicta logo
Water resistant: 100 meters



Model 6101



Model 6099



Model 6103

INVICTA

LUPAH REVOLUTION

Movement: Professional Swiss made chronograph
Case and dial: ø 46.8 mm • Solid stainless steel case • Screw-on Stainless steel case back
 • Flame fusion crystal • Sunray dial with 3D hand applied graphics • Date display
 • Tritnite® luminous hands
Band: High grade polyurethane strap • Stainless steel buckle with etched Invicta logo
Water resistant: 100 meters



Model 6100



Model 6098

INVICTA

LUPAH REVOLUTION

Movement: Professional Swiss made chronograph

Case and dial: ø 46.8 mm • Solid stainless steel case • Screw-on Stainless steel case back

- Flame fusion crystal • Sunray dial with 3D hand applied graphics • Date display • Tritnite® luminous hands • Black ionic plating

Band: High grade polyurethane strap

- Stainless steel buckle with black ionic plating and etched Invicta logo

Water resistant: 100 meters



Model 6724



Model 6725



Model 6726

INVICTA

LUPAH REVOLUTION

Movement: Professional Swiss made chronograph

Case and dial: ø 46.8 mm • Solid stainless steel case • Screw-on Stainless steel case back

- Flame fusion crystal • Sunray dial with 3D hand applied graphics • Date display • Tritnite® luminous hands • Black ionic plating

Band: High grade polyurethane strap

- Stainless steel buckle with black ionic plating and etched Invicta logo

Water resistant: 100 meters



Model 6727



Model 6728



Model 6729



Model 6730

INVICTA

LADY LUPAH REVOLUTION

Movement: Professional Swiss made chronograph movement • 13 jewels

Case and dial: ø 36 mm • Solid stainless steel case • Stainless steel case back with screw

- Flame fusion crystal • Sunray double layer dial with 3D applied arabic & dots in assorted colors
- Date display • Tritnite® luminous hands

Band: Croco-pattern leather band in assorted colors with tone on tone fish-bones stitching

- Stainless steel buckle with etched logo

Water resistant: 100 meters



Model 6794



Model 6800



Model 6797



Model 6795



Model 6801



Model 6798

INVICTA
LUPAH
THE LAST WORD
ON BOLD MOVEMENTS

INVICTA Angel COLLECTION

Divine Messengers of Time

Patterns of ethereal energy connect time to a higher plane with the Invicta Angel Collection. Harmonizing a perfect balance between time and style, watches of graceful diversity comprise Angel. Designed with a touch from above, Angel offers an array of selections to satisfy any mood, occasion or taste.

Highlighting the aspects of feminine prowess, the Invicta Angel Collection knows no bounds, transcending earthly planes and achieving the quintessential in keeping time.



INVICTA

DIAMOND ANGEL QUARTZ

Movement: Professional quartz

Case and dial: ø 38 mm • Stainless steel case with unidirectional rotating bezel • 18kt gold plating
 • Flame fusion crystal • Stainless steel screw down case back • Genuine mother of pearl dials
 with 51 genuine white diamonds hand set on index positions • Tritnite® luminous hands • Date display

Band: High grade polyurathane strap

Water resistant: 100 meters



Model 0498
MOP



Model 0497
MOP



Model 0495
MOP



Model 0493
MOP



Model 0494
MOP



Model 0496
MOP



INVICTA
Angel
COLLECTION

Divine Messengers of Time

INVICTA

ROSE ANGEL QUARTZ

Movement: Professional quartz

- Case and dial: ø 38 mm • Stainless steel case with unidirectional rotating bezel • 18kt gold plating
 • Flame fusion crystal • Stainless steel screw down case back
 • Genuine mother of pearl dials with Cubic Zirconia stones • Tritnite® luminous hands • Date display

Band: High grade polyurethane strap

Water resistant: 100 meters



Model 0489
MOP



Model 0488
MOP



Model 0487
MOP



Model 0486
MOP



INVICTA
Angel
COLLECTION

Divine Messengers of Time

INVICTA

ANGEL JELLY FISH

Movement: Professional quartz

Case and dial: ø 38 mm • Solid stainless steel in combination brushed and polished finished
 • Unidirectional plastic rotating bezel • White mineral crystal • Enamel dial • Tritnite® luminous hands
 Band: Silicon strap with stainless steel buckle
 Water resistant: 30 meters



Model 0733



Model 0735



Model 0734



Model 0698



Model 0697



Model 0700



Model 0696



Model 0695



White Box Packaging



Model 0699



Model 0702



Model 0701

INVICTA

ANGEL JELLY FISH

Movement: Professional quartz

Case and dial: ø 38 mm • Solid stainless steel in combination brushed and polished finished
 • Unidirectional plastic rotating bezel • White mineral crystal • Enamel dial • Tritnite® luminous hands
 Band: Silicon strap with stainless steel buckle
 Water resistant: 30 meters

INVICTA

ANGEL JELLY FISH

Movement: Professional quartz

Case and dial: ø 38 mm • Solid stainless steel in combination brushed and polished finished
 • Unidirectional plastic rotating bezel • White mineral crystal • Enamel dial • Tritnite® luminous hands
 Band: Silicon strap with stainless steel buckle
 Water resistant: 30 meters



Model 0704



Model 0703



Model 0706



Model 0708



Model 0707



Model 0710



Model 0705



White Box Packaging



Model 0709



White Box Packaging

INVICTA

ANGEL JELLY FISH

Movement: Professional quartz

Case and dial: ø 38 mm • Solid stainless steel in combination brushed and polished finished
 • Unidirectional plastic rotating bezel • White mineral crystal • Enamel dial • Tritnite® luminous hands
 • 18kt gold plating
 Band: Silicon strap with stainless steel buckle • 18kt gold plating
 Water resistant: 30 meters

INVICTA
ANGEL JELLY FISH

Movement: Professional quartz

Case and dial: ø 38 mm • Solid stainless steel in combination brushed and polished finished
• Unidirectional plastic rotating bezel • White mineral crystal • Enamel dial • Tritnite® luminous hands
• 18kt rose gold plating
Band: Silicon strap with stainless steel buckle • 18kt rose gold plating
Water resistant: 30 meters



Model 0712



Model 0711



Model 0714

INVICTA
ANGEL JELLY FISH

Movement: Professional quartz

Case and dial: ø 38 mm • Solid stainless steel in combination brushed and polished finished
• Unidirectional plastic rotating bezel • White mineral crystal • Enamel dial • Tritnite® luminous hands
• 18kt rose gold plating • 18kt gold plating
Band: Silicon strap with stainless steel buckle • 18kt rose gold plating • 18kt gold plating
Water resistant: 30 meters



Model 0716



Model 0715



Model 0718



Model 0713



White Box Packaging



Model 0717



White Box Packaging

INVICTA

LADY ANGEL QUARTZ

Movement: Professional quartz

Case and dial: ø 38 mm • Stainless steel case with unidirectional rotating bezel • 18kt gold plating

• Flame fusion crystal • Stainless steel screw down case back • Genuine mother of pearl dials

• Tritnite® luminous hands and indexes • Date display

Band: High grade polyurethane strap

Water resistant: 100 meters



Model 0485
MOP



Model 0484
MOP



Model 0483
MOP



Model 0481
MOP



Model 0482
MOP



INVICTA
Angel
COLLECTION

Divine Messengers of Time

INVICTA

ANGEL DIVER

Movement: Professional quartz

- Case and dial:** ø 36 mm • Solid stainless steel case • Unidirectional rotating bezel
- Screw down solid stainless steel case back • Stainless steel crown with logo • Flame fusion crystal
 - Gold textured dial in assorted colors • Tritnite® luminous hands • 18kt gold plating

Band: High grade polyurethane strap with metal insert in 18kt gold plating

- Stainless steel buckle with etched logo • 18kt gold plating

Water resistant: 100 meters



Model 5917



Model 5919



Model 5920



Model 5916



Model 5918



Model 5921



Model 5922



Model 5924



Model 5926



Model 5923



Model 5925



Model 5927

INVICTA

ANGEL DIVER

Movement: Professional quartz

- Case and dial:** ø 36 mm • Solid stainless steel case • Unidirectional rotating bezel
- Screw down solid stainless steel case back • Stainless steel crown with logo • Flame fusion crystal
 - Silver textured dial in assorted colors • Tritnite® luminous hands

Band: High grade polyurethane strap with metal insert in steel

- Stainless steel buckle with etched logo

Water resistant: 100 meters

INVICTA

ANGEL DIAMOND CHRONO

Movement: Professional quartz chronograph

Case and dial: ø 39 mm • Stainless steel case • 18kt gold plating • 18kt rose gold plating

• Flame fusion crystal • Stainless steel crown and pushers

• 12 genuine white diamonds hand set on the top ring in a 4 prong jeweler's setting

• Stainless steel screw down case back • Genuine mother of pearl dials • Tritnite® luminous hands

Band: Genuine leather

Water resistant: 100 meters



Model 0581
MOP



Model 0582
MOP



Model 0578
MOP



Model 0579



Model 0580



Model 0577

INVICTA

ANGEL DIAMOND CHRONO

Movement: Professional quartz chronograph

Case and dial: ø 39 mm • Stainless steel case with fixed top ring • 18kt gold plating • Flame fusion crystal

• Stainless steel crown and pushers • 12 genuine white diamonds hand set on the top ring

in a 4 prong jeweler's setting • Stainless steel screw down case back • Sunray dials in assorted colors

with genuine mother of pearl sub dials • Tritnite® luminous hands

Band: Genuine leather

Water resistant: 100 meters

INVICTA

ANGEL DIAMOND ANDRASTE

Movement: Professional quartz

Case and dial: ø 38 mm • Solid stainless steel case • 18kt gold plating • Flame fusion crystal
• Stainless steel screw down case back • Genuine mother of pearl dial with total 42 white diamonds set on index positions • Tritnite® luminous hands • Date display

Band: Genuine leather

Water resistant: 50 meters



Model 0770
MOP



Model 0771
MOP



Model 0772
MOP



Model 0773
MOP

INVICTA

ANGEL DIAMOND ANDRASTE

Movement: Professional quartz

Case and dial: ø 38 mm • Solid stainless steel case • 18kt rose gold plating • Flame fusion crystal
• Stainless steel screw down case back • Genuine mother of pearl dial with total 42 white diamonds set on index positions • Tritnite® luminous hands • Date display

Band: Genuine leather

Water resistant: 50 meters



Model 0774
MOP



Model 0775
MOP



Model 0776
MOP

INVICTA

ANGEL DIAMOND ANDRASTE

Movement: Professional quartz

Case and dial: ø 38 mm • Solid stainless steel case with fixed top ring • Flame fusion crystal
• Stainless steel screw down case back • Genuine mother of pearl dial with total 42 white diamonds set on index positions • Tritnite® luminous hands • Date display

Band: Genuine leather

Water resistant: 50 meters



Model 0766
MOP



Model 0767
MOP



Model 0768
MOP



Model 0769
MOP



INVICTA
Angel
COLLECTION

Divine Messengers of Time

INVICTA

DIAMOND ANGEL ELEGANCE

Movement: Professional quartz

Case and dial: ø 30 mm • Stainless steel case • Flame fusion crystal • 20 genuine white diamonds hand set on the case lugs in a 4 prong Jeweler's setting • Sunray dials in assorted colors

Band: Genuine leather

Water resistant: 30 meters



Model 0583



Model 0584



Model 0585



Model 0586

INVICTA

DIAMOND ANGEL ELEGANCE

Movement: Professional quartz

Case and dial: ø 30 mm • Stainless steel case • 18kt rose gold plating • Flame fusion crystal • 20 genuine white diamonds hand set on the case lugs in a 4 prong Jeweler's setting • Sunray dials in assorted colors

Band: Genuine leather

Water resistant: 30 meters



Model 0587



Model 0588



Model 0589

INVICTA

ANGEL CLASSIQUE

Movement: Professional quartz multi function

Case and dial: ø 38 mm • Solid stainless steel case • 18kt gold plating

- Stainless steel screw down case back • Flame fusion crystal • Stainless steel crown and pushers
- Genuine mother of pearl dials • Day, date and dual time display

Band: Solid stainless steel band with diver buckle and safety clasp

Water resistant: 50 meters



Model 0466



Model 0465
MOP



Model 0463
MOP



Model 0464



Model 0461



Model 0462

INVICTA

ANGEL CLASSIQUE

Movement: Professional quartz multi function

Case and dial: ø 38 mm • Solid stainless steel case • 18kt gold plating

- Stainless steel screw down case back • Flame fusion crystal • Stainless steel crown and pushers
- Sunray dials • Day, date and dual time display

Band: Solid stainless steel band with diver buckle and safety clasp

Water resistant: 50 meters

INVICTA
ANGEL CLASSIQUE QUARTZ

Movement: Professional quartz

Case and dial: ø 38 mm • Solid stainless steel case • 18kt gold plating

- Stainless steel screw down case back • Flame fusion crystal • Stainless steel crown
- Sunray dials / Genuine mother of pearl dials

Band: Solid stainless steel band with diver buckle and safety clasp

Water resistant: 50 meters



Model 0460
MOP



Model 0459



Model 0458
MOP



Model 0457

INVICTA
ANGEL ELEGANT QUARTZ

Movement: Professional quartz

Case and dial: ø 33.5 mm • Solid stainless steel in combination brushed and polished finishes

- Flame fusion crystal • Sunray dial • Tritnite® luminous hands

Band: Stainless steel band with stainless steel buckle

Water resistant: 30 meters



Model 0553



Model 0552



Model 0551

INVICTA
ANGEL SPORT ELEGANCE

Movement: Professional quartz

Case and dial: ø 33 mm • Solid stainless steel in combination brushed and polished finishes
• Unidirectional rotating bezel • Flame fusion crystal • Sunray dial • 18kt rose gold plating
• 18kt gold plating • Tritnite® luminous hands
Band: Stainless steel band with stainless steel buckle

Water resistant: 30 meters



Model 0550



Model 0548



Model 0549



Model 0546



Model 0547

INVICTA
ANGEL SPORT ELEGANCE

Movement: Professional quartz

Case and dial: ø 33 mm • Solid stainless steel in combination brushed and polished finishes • Stainless steel screw down case back • Flame fusion crystal • Genuine mother of pearl dial • Tritnite® luminous hands
Band: Solid stainless steel in combination brushed and polished finish
Water resistant: 30 meters



Model 0544
MOP



Model 0545
MOP



Model 0542
MOP



Model 0543
MOP

INVICTA II

A COMPILATION

Twice the Value. Twice the Smarts.

In the wake of up to the minute technology, optimal construction, and a spectrum of inventive design choices you will find the Invicta II collection. Priced to demand attention, no technological or creative rock has been left unturned in order to create such an impeccable example of the ultimate in function and fashion. Invicta II offers a myriad of enticing options including applied indexes, up markers, double-dial dual timers, leather straps, carbon-fiber dials, retrograde chronographs, and moon phase registers. Having fused brains and good looks at a stellar price, the Invicta II is the perfect collection to indulge in all your watch fantasies.



INVICTA

CLASSIC SWISS CHRONO

Movement: Professional chronograph

Case and dial: ø 45 mm • Solid stainless steel in combination brushed and polished finishes

- Stainless steel screw down case back • Flame fusion crystal • Enamel sunray dial
- Tritnite® luminous hands • Date display

Band: Solid stainless steel in combination brushed and shiny finish

Water resistant: 100 meters



Model 0080



Model 0079



Model 0078

INVICTA

CLASSIC MILITARY BLACK CARBON

Movement: Professional quartz

Case and dial: ø 48 mm • Solid stainless steel in combination brushed and polished finished

- Screw down stainless steel case back • Flame fusion crystal • Carbon fibre dial • Tritnite® luminous hands
- Date display

Band: Stainless steel band with stainless steel buckle

Water resistant: 100 meters



Model 0369



Model 0368

INVICTA
SPORTS CHRONO

Movement: Professional chronograph

Case and dial: ø 45 mm • Solid stainless steel case with one unidirectional rotating bezel
• Screw down stainless steel case back • Flame fusion crystal • Sunray dial • Date display
• Tritnite® luminous hands and markers

Band: Solid stainless steel in combination brushed and shiny finish

Water resistant: 100 meters



Model 0623

Model 0622

Model 0624

INVICTA
SPORTS CHRONO

Movement: Professional chronograph

Case and dial: ø 45 mm • Solid stainless steel case with one unidirectional rotating bezel
• Screw down stainless steel case back • Flame fusion crystal • Sunray dial • Date display
• Tritnite® luminous hands and markers

Band: Solid stainless steel in combination brushed and shiny finish

Water resistant: 100 meters



Model 0621

Model 0620

INVICTA

SWISS SPORTS CHRONO

Movement: Professional chronograph

Case and dial: ø 45 mm • Solid stainless steel case with one unidirectional rotating bezel
• Screw down stainless steel case back • Flame fusion crystal • Sunray dial • Date display
• Tritnite® luminous hands and markers

Band: Solid stainless steel in combination brushed and shiny finish

Water resistant: 100 meters



Model 0619



Model 0618



Model 0617



Model 0616

INVICTA

SWISS SPORTS CHRONO

Movement: Professional chronograph

Case and dial: ø 45 mm • Solid stainless steel case with one unidirectional rotating bezel
• Screw down stainless steel case back • Flame fusion crystal • Sunray dial • Date display
• Tritnite® luminous hands and markers

Band: Solid stainless steel in combination brushed and shiny finish

Water resistant: 100 meters

INVICTA

TACHYMETER SPORTS CHRONO

Movement: Professional chronograph

Case and dial: ø 45 mm • Solid stainless steel case with one unidirectional rotating bezel
• Screw down stainless steel case back • Flame fusion crystal • Sunray dial • Date display
• Tritnite® luminous hands and markers

Band: Solid stainless steel in combination brushed and shiny finish

Water resistant: 100 meters



Model 6857



Model 6856



Model 6858



Model 6855



Model 6854

INVICTA

TACHYMETER SPORTS CHRONO

Movement: Professional chronograph

Case and dial: ø 45 mm • Solid stainless steel case with one unidirectional rotating bezel
• Screw down stainless steel case back • Flame fusion crystal • Sunray dial • Date display
• Tritnite® luminous hands and markers

Band: Solid stainless steel in combination brushed and shiny finish

Water resistant: 100 meters

INVICTA

INVICTA II MILITARY

Movement: Professional quartz

Case and dial: ø 48 mm • Solid stainless steel in combination brushed and polished finished
• Screw down stainless steel case back • Flame fusion crystal • Sunray dial • Tritnite® luminous hands
• Date display

Band: Stainless steel band with stainless steel buckle

Water resistant: 100 meters



Model 0366

Model 0365

Model 0367

INVICTA

MILITARY II QUARTZ

Movement: Professional quartz

Case and dial: ø 48 mm • Solid stainless steel in combination brushed and polished finished
• Screw down stainless steel case back • Flame fusion crystal • Sunray dial • Tritnite® luminous hands
• Date and day display

Band: Stainless steel band with stainless steel buckle

Water resistant: 100 meters



Model 0450

Model 0371

Model 0370

INVICTA

CLASSIC QUARTZ LEATHER

Movement: Professional quartz

Case and dial: ø 48 mm • Solid stainless steel in combination brushed and polished finished

- Stainless steel screw down case back • Flame fusion crystal • Carbon fibre dial • Tritnite® luminous hands
- Date display

Band: Genuine leather

Water resistant: 100 meters



Model 0384



Model 0449



Model 0385

INVICTA

CLASSIC QUARTZ STEEL

Movement: Professional quartz

Case and dial: ø 45 mm • Solid stainless steel in combination brushed and polished finish

- Unidirectional rotating bezel • Stainless steel screw down case back • Flame fusion crystal
- Enamel sunray dial • Tritnite® luminous hands • Date display

Band: Solid stainless steel in combination brushed and shiny finish

Water resistant: 100 meters



Model 0085



Model 0083



Model 0092



Model 0090

INVICTA

CLASSIC QUARTZ STEEL

Movement: Professional quartz

Case and dial: ø 45 mm • Solid stainless steel in combination brushed and polished finish
 • Unidirectional rotating bezel • Stainless steel screw down case back • Flame fusion crystal
 • Enamel sunray dial • Tritnite® luminous hands • Date display
 Band: Solid stainless steel in combination brushed and shiny finish
 Water resistant: 100 meters



Model 0086



Model 0087



Model 0093



Model 0094

INVICTA

CLASSIC QUARTZ STEEL

Movement: Professional quartz

Case and dial: ø 45 mm • Solid stainless steel in combination brushed and polished finish
 • Unidirectional rotating bezel • Stainless steel screw down case back • Flame fusion crystal
 • Enamel sunray dial • Tritnite® luminous hands • Date display
 Band: Solid stainless steel in combination brushed and shiny finish
 Water resistant: 100 meters



Model 0081



Model 0082



Model 0084



Model 0088



Model 0089



Model 0091

INVICTA
PYTHON CHRONOGRAPH

Movement: Professional chronograph

- Case and dial: ø 46 mm • Solid stainless steel in combination brushed and polished finished
- Unidirectional rotating bezel • Screw down stainless steel case back • Enamel dial with sunray polishing
 - Date display • Tritnite® luminous hands • Black ionic plating • Gun ionic plating
- Band: Solid stainless steel band with stainless steel diver buckle with safety lock
- Black ionic plating • Gun ionic plating
- Water resistant: 100 meters



Model 6412



Model 6411



Model 6410



Model 6407



Model 6408



Model 6409

INVICTA
PYTHON CHRONOGRAPH

Movement: Professional chronograph

- Case and dial: ø 46 mm • Solid stainless steel in combination brushed and polished finished
- Unidirectional rotating bezel • Screw down stainless steel case back
 - Enamel dial with sunray polishing • Date display • Tritnite® luminous hands • Black ionic plating
- Band: Solid stainless steel band with stainless steel diver buckle with safety lock • Black ionic plating
- Water resistant: 100 meters

INVICTA
PYTHON CHRONOGRAPH

Movement: Professional chronograph
Case and dial: ø 46 mm • Solid stainless steel in combination brushed and polished finished
• Unidirectional rotating bezel • Screw down stainless steel case back
• Enamel dial with sunray polishing • Date display • Tritnite® luminous hands
Band: Solid stainless steel band with stainless steel diver buckle with safety lock
Water resistant: 100 meters



Model 6413



Model 6414

INVICTA
SPORT CHRONO STEEL ELITE

Movement: Sport chronograph
Case and dial: ø 44 mm • 316L solid stainless steel case • Flame fusion crystal
• Ceramic dial with up markers • Tritnite® luminous hands
• 18kt gold plating • 18kt rose gold plating • Black ionic plating
Band: 316L solid stainless steel bracelet with stainless steel buckle
Water resistant: 100 meters



Model 4889



Model 4890



Model 4891



Model 4894



Model 4892



Model 4893

INVICTA

GENT'S SWISS MULTIFUNCTION DIAMOND

Movement: Swiss chronograph

Case and dial: ø 42 mm • Solid stainless steel case • Stainless steel fixed bezel set with 32 diamonds

• Flame fusion crystal • 18kt gold plating • Mother of pearl dial with applied index markers

Band: Solid stainless steel bracelet with solid butterfly buckle • 18kt gold plating

Water resistant: 50 meters



Model 4743
MOP



Model 4742
MOP



Model 4741
MOP

INVICTA

LADIES SWISS MULTIFUNCTION DIAMOND

Movement: Swiss chronograph

Case and dial: ø 33 mm • Solid stainless steel case • Stainless steel fixed bezel set with 16 diamonds

• Flame fusion crystal • 18kt gold plating

• Mother of pearl dial with applied index markers • Date display

Band: Solid stainless steel bracelet with solid butterfly buckle • 18kt gold plating

Water resistant: 50 meters



Model 4720
MOP



Model 4719
MOP



Model 4718
MOP

INVICTA
DIAMOND GLAMOUR

Movement: Professional quartz movement

Case and dial: 0236, 0241: ø 23 mm • 0238, 0242: ø 24mm • Solid stainless steel • 12 white diamonds
• Flame fusion crystal • Genuine mother of pearl dial

Band: Solid stainless steel

Water resistant: 50 meters



Model 0236
MOP



Model 0238
MOP



Model 0241
MOP



Model 0242
MOP



Model 0240
MOP



Model 0239
MOP



Model 0237
MOP

INVICTA
DIAMOND GLAMOUR

Movement: Professional quartz movement

Case and dial: 0237: ø 23 mm • 0239: ø 24mm • 0240: ø 32mm • Solid stainless steel • 12 white diamonds
• Flame fusion crystal • Genuine mother of pearl dial

Band: Solid stainless steel

Water resistant: 50 meters

INVICTA
LADY DIAMOND ACCENT

Movement: Professional quartz

- Case and dial: ø 33 mm • Surgical grade solid stainless steel case set with 16 white diamonds
• 18kt gold plating • Screw down stainless steel case back • Flame fusion crystal • Mother of pearl dial
• Tritnite® luminous hands • Date display
Band: Stainless steel bracelet with stainless steel buckle
Water resistant: 100 meters



Model 0268
MOP



Model 0267
MOP



Model 0269
MOP



Model 0266
MOP

INVICTA
LADY DIAMOND ACCENT

Movement: Professional quartz movement

- Case and dial: ø 31 mm • Solid stainless steel in combination brush and shiny finish • 18kt gold plating
• Unidirectional turning bezel • 12 genuine white diamonds • Flame fusion crystal
• Stainless steel screw down case back • Mother of pearl dial • Tritnite® luminous hands and indexes
• Date display
Band: Solid stainless steel with Diver buckle and safety lock
Water resistant: 100 meters



Model 0244
MOP



Model 0243
MOP

INVICTA

LADY ELEGANCE

Movement: Professional quartz

Case and dial: ø 33.5 mm • Surgical grade solid stainless steel case • Screw down stainless steel case back
• Flame fusion crystal • Mother of pearl dial • Tritnite® luminous hands • 18kt gold plating

• 18kt rose gold plating

Band: Stainless steel band with stainless steel buckle • 18kt gold plating • 18kt rose gold plating

Water resistant: 100 meters



Model 0264
MOP



Model 0263
MOP



Model 0265
MOP



Model 0262
MOP



INVICTA II

A COMPILATION

Twice the Value. Twice the Smarts.

INVICTA
JEWELRY
MADE IN ITALY

Adorn your day with Elements, Invicta's boldly striking accessory line. Classically cool bracelets for the wrist, Russian Diver inspired charms for the neck, rotor links for the cuffs, and sleek writing instruments for the hands are wonderful companions to any Invicta timepiece or for making a statement entirely all their own.

Choose these immaculately appointed accents to piece together the Elements of your day.

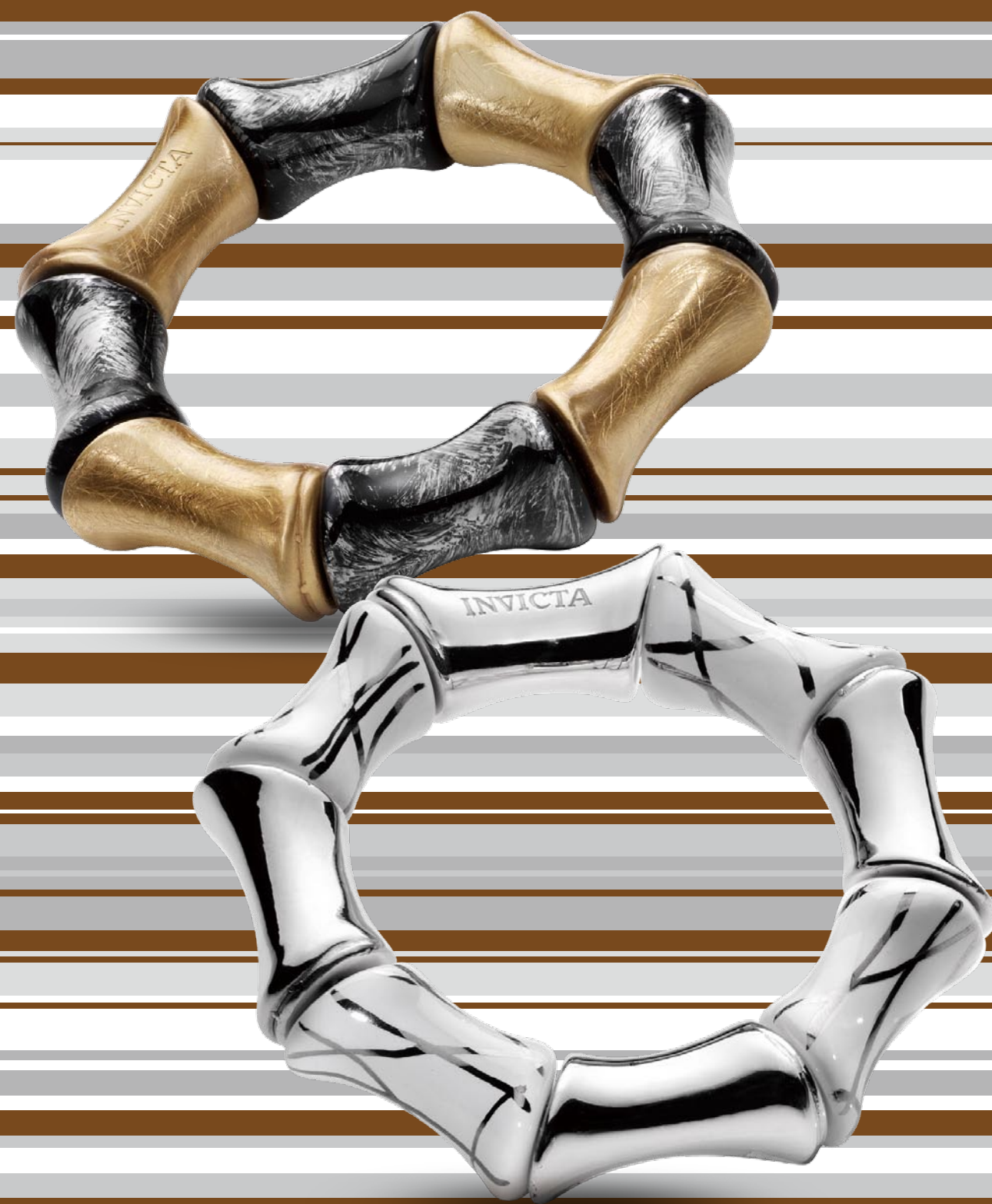

INVICTA

INVICTA INCANTO

Silver • 18kt rose gold plating • Hand painted white ceramic



J0046
Adjustable Ring



J0055
Earrings



J0049
21cm Bracelet



J0052
60cm Necklace

INVICTA

INVICTA INCANTO

Silver • Rhodium plating • Hand painted white ceramic



J0053
60cm Necklace



J0047
Adjustable Ring



J0044
100cm Necklace



J0043
22cm Bracelet

INVICTA

INVICTA INCANTO

Silver • Rhodium plating • 18kt rose gold plating • Hand painted white ceramic



INVICTA

INVICTA INCANTO

Silver • 18kt rose gold plating • Hand painted white ceramic



INVICTA

INVICTA INCANTO

Silver • Rhodium plating • 18kt yellow gold plating • Hand painted white ceramic
• Hand painted black ceramic



J0076
9cm Bracelet



J0077
9cm Bracelet

INVICTA

INVICTA INCANTO

Silver • 24kt yellow gold plating • Hand painted black ceramic



J0050
21cm Bracelet

J0054
60cm Necklace

J0045
Adjustable Ring

J0051
60cm Necklace

J0048
21cm Bracelet

INVICTA

INVICTA INCANTO

Silk and silver mesh necklace • Rhodium plating • 24kt yellow gold plating



INVICTA

INVICTA INCANTO

Silver • 24kt yellow gold plating • 18kt chocolate gold plating • Hand painted black ceramic



INVICTA

INVICTA INCANTO

Silver • 18kt chocolate gold plating • 24kt yellow gold plating • Vegetable ivory

J0020
9cm Expandable Bracelet



J0019
19cm Expandable Necklace

INVICTA

INVICTA GRAZIA

Silver • Rhodium plating • 24kt yellow gold plating • 18kt rose gold plating • Scratch texture finish



J0025
Adjustable Cuff Bracelet



J0026
Adjustable Cuff Bracelet



J0024
Adjustable Cuff Bracelet

INVICTA

INVICTA GRAZIA

Silver • Rhodium plating • Scratch texture finish • Hand painted white ceramic



INVICTA

INVICTA GRAZIA

Silver • Rhodium plating • Scratch texture finish • Hand painted white ceramic



INVICTA

INVICTA PARADISO

Silver • 24kt gold plating • Ruthenium plating • Wenge wood

J0073
80cm Necklace



J0075
Earrings



J0072
24cm Bracelet



INVICTA

INVICTA PARADISO

Silver • 24kt yellow gold plating • Wenge wood

J0083
Earrings



J0079
20cm Bracelet



J0081
70cm Necklace



INVICTA

INVICTA PARADISO

Silver • Rhodium plating • Wenge wood



J0082
Earrings



J0078
20cm Bracelet



J0080
68cm Necklace

INVICTA

INVICTA PARADISO

Silver • Rhodium plating • Wenge wood



J0084
Adjustable Ring



J0090
Earrings



J0086
20cm Bracelet



J0088
70cm Necklace

INVICTA

INVICTA PARADISO

Silver • 24kt yellow gold plating • Wenge wood



J0091
Earrings



J0085
Adjustable Ring



J0087
20cm Bracelet



J0089
70cm Necklace

INVICTA

INVICTA LUCE

Silver • Rhodium plating • Onyx and agate



J0035
Adjustable Ring



J0037
Adjustable Bracelet



J0040
60cm Necklace

INVICTA

INVICTA LUCE

Silver • Rhodium plating • Onyx and agate



J0034
Adjustable Ring



J0036
Adjustable Bracelet



J0039
90cm Necklace

INVICTA

INVICTA LUCE

Silver • Rhodium plating



J0038
19.5cm Bracelet



J0042
Earrings



J0041
45cm Necklace

INVICTA
INVICTA DIVINA

Silver • Rhodium plating • Black enamel



INVICTA
INVICTA DIVINA

Silver • 18kt yellow gold plating • Black enamel



INVICTA
INVICTA GIUSTO

Silver • Rhodium plating • 18kt rose gold plating • Polished agate and onyx • Natural rubber



J0002
22cm Bracelet



J0001
22cm Bracelet



J0003
22cm Bracelet

INVICTA
INVICTA GIUSTO

Silver • Rhodium plating • Leather • Available in Small - 21cm, Large - 23cm



Bracelet
SM J0013
LM J0012

Bracelet
SM J0011
LM J0010

Bracelet
SM J0007
LM J0006



Bracelet
SM J0009
LM J0008

Bracelet
SM J0005
LM J0004



INVICTA PACKAGING & DISPLAY

SHOW SOME GUTS OR PACK IT IN

In showcasing some of the most diverse collections of timepieces, thinking out of the box has been a must for Invicta. Redefining packaging to fit an ever-growing brand, while providing an impactful set-up for every style, Invicta packaging & display stand out, exhibiting pride of their own.



INVICTA

SPECIAL EDITION RESERVE GIFT BOX

RESERVE GIFT BOX

Dimensions: 146mm (L) x 130mm (D) x 115mm (H)



IPM 112

RESERVE CLASSIC GIFT BOX

• New wave design • Dimensions: 146mm (L) x 130mm (D) x 115mm (H)



IPM 109

INVICTA

WATCH COLLECTOR BOXES

INVICTA CLASSIC COLLECTOR BOX

• New wave design • Dimensions: 354mm (L) x 215mm (D) x 120mm (H)



IPM 113

RESERVE COLLECTOR BOX

Dimensions: 354mm (L) x 215mm (D) x 120mm (H)



IPM 116

INVICTA

SHOP IN SHOP

In Shop branded Invicta Collections display system with flat screen for Viewing 3D Invicta watch animations. For more information please contact your local distributor.

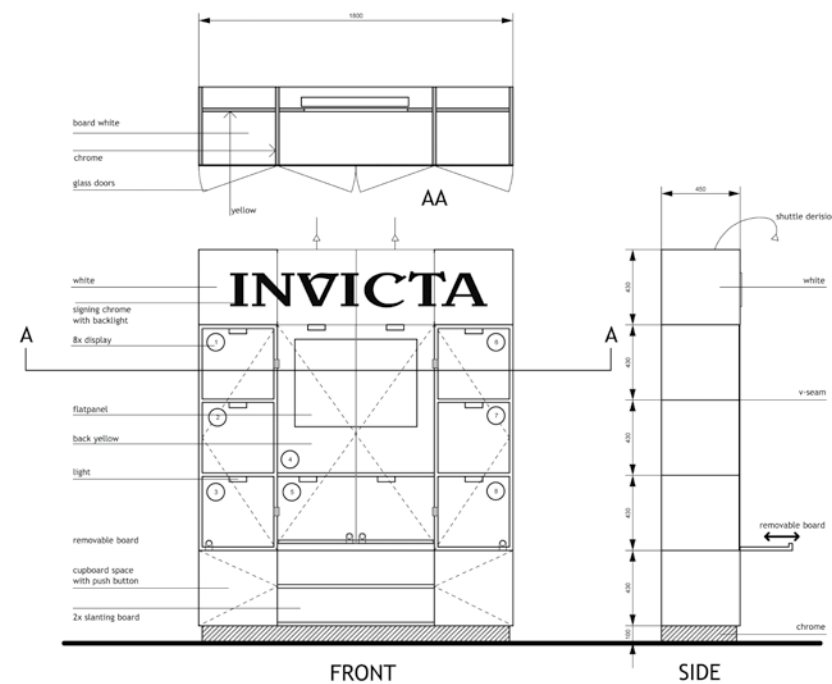

INVICTA



INVICTA

INVICTA GIFT BOX

INVICTA STANDARD GIFT BOX

Standard gift box for every Invicta watch • New wave design

Dimensions: 148mm (L) X 113mm (D) X 92mm (H)



IPM 80

INVICTA CLASSIC MIDSIZE GIFT BOX

• New wave design • Dimensions: 146mm (L) x 130mm (D) x 115mm (H)



IPM 108

INVICTA

INVICTA PROMOTIONAL BAG

Available for promotional use.



IPM 24